

Panic, Lock and Bolting Technology

Always on the safe side.



If panic breaks out

Panic bolting technology ensures that people can get out of a danger zone at any time, even in a panic situation. One push on the horizontal activation element is all it takes and the door springs open – irrespective of whether it was locked or not.



ECO unlocking solutions also open up the escape route when a crowd of people press against the door. And even the strength of a child is sufficient to open the door to escape from a fire or toxic smoke.

ECO bolting technology satisfies European standards **EN 1125** (Panic locks with horizontal activation bars) and **EN 179** (Emergency exit locks with handles or impact plates) – and demonstrates the company's expertise. The lock and release element are developed and manufactured in coordination with one another.

With panic systems in particular, it is important to perceive the door as a system, because it's not only the panic lock, door lock and fitting that have to interact perfectly so that the door can help in a life-threatening situation. The door closer and hinges have a decisive influence on the ability to satisfy the high demands set by the standard.

Differentiation by building utilization

The type of room and utilization of the building are decisive when choosing the right panic door combination. European standards **DIN EN 1125** and **DIN EN 179** define the fittings of panic doors and emergency exits. Emergency exit locks in compliance with **DIN EN 179** are not normally subjected to use by the general public. It is assumed here that the users of the building are acquainted with the escape routes, so conventional panic lock technology with a handle or impact plate are sufficient here. Panic locks with a horizontal activation bar in accordance with **DIN EN 1125**, on the other hand, are intended for use in buildings frequented by the general public. Our panic systems in conformance with **DIN EN 1125** ensure that persons who have panicked and are not acquainted with the functions of the door can always get out of the building safely.

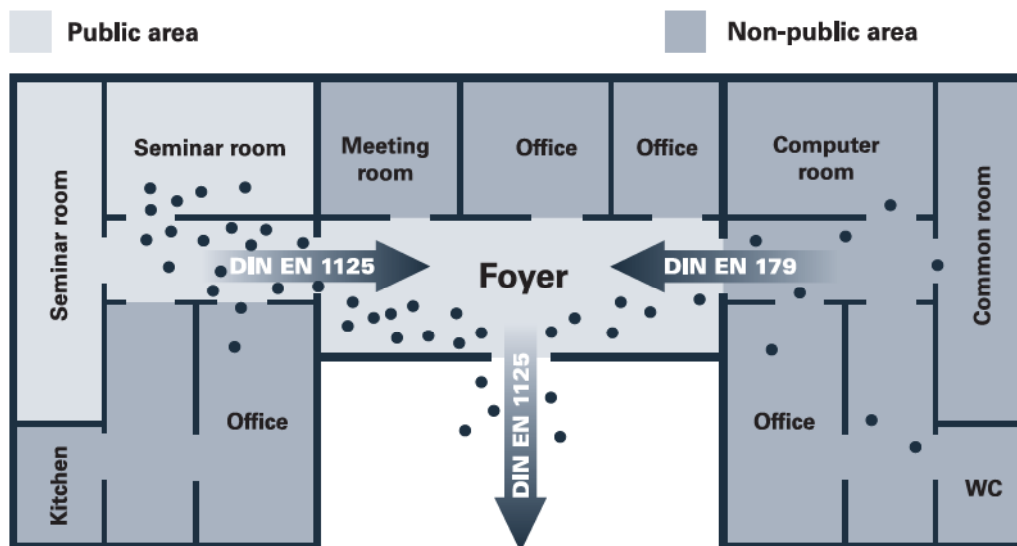

Panic locks with a horizontal activation bar

EN 1125 

Panic locks in accordance with **DIN EN 1125** are used in public buildings in which the users are not acquainted with the functioning of the escape door but must nevertheless be able to operate them without instruction.

Panic locks activated mechanically by means of a horizontal handle or push-bar.

Areas of application:

- Hospitals and clinics
- Escape routes in schools and training centres
- Public administration buildings
- Stadia, arenas and events buildings
- Shopping centres

Users have **no** advance knowledge of how to open the escape door.

Emergency exit locks with door handle

EN 179 

Emergency exit locks in accordance with **DIN EN 179** for buildings or building sections not open to the general public and all areas where access by the general public can be excluded. Side entrances or doors in these buildings or building sections are only used by authorized persons.

Emergency exit locks operated mechanically by means of a handle or impact plate.

Areas of application:

- Private residential complexes
- School classrooms
- Non-public administration buildings or industrial companies
- Non-public areas of administrative buildings
- Non-public areas of airports, banks, shopping centres

Users have advance knowledge of how to open the escape door.

Clarity through marking

Whether or not a product complies with the standard, thus acquiring approval for use in escape and rescue routes, can be seen from a classification code on the product

Classification Code DIN EN 1125

The standard requires that all products tested for compliance with it be classified with a 9-digit code. Here is the classification code of the ECO EPN 900 Pushbar:

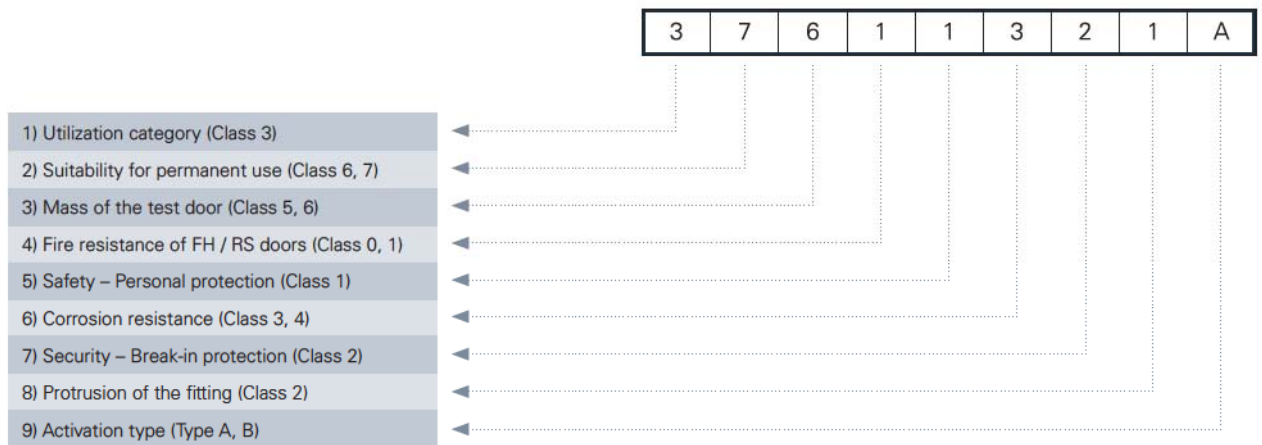

Example of a CE marking

The CE marking documents that a product complies with standards. The example given here is for the ECO panic lock system EPN 900 tested in accordance with **DIN EN 1125**. With the CE marking, the manufacturer documents that his product complies with the applicable EU directives.

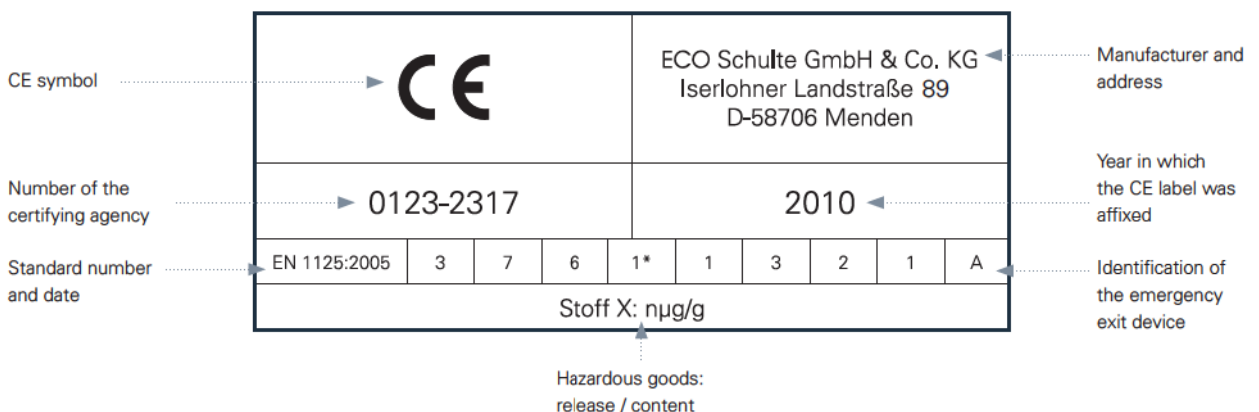

Panic door combinations

ECO panic door fittings: Screw-on safety and security

ECO Schulte fittings for escape and rescue route doors guarantee easy opening in an emergency. Even if the doors are locked shut, they can be opened without a key in accordance with standards with only one simple hand movement using a force of max. 80 N. The door fittings are designed in such a way that there is no risk of clothing getting caught in them when people flee the building. The free end of the door handle is returned in the direction of the door surface at an angle of at least 30 degrees in order to preclude the obstruction of fleeing persons and the risk of injury by the door handle.



Panic door combinations – tested jointly

ECO Schulte considers panic door combinations to be a perfectly coordinated system. Only the perfect interplay of all components guarantees perfect conformity with the standard right down to the last detail. Although the lock, fitting and triggering mechanism are the key functions of this panic door combination, the use of a coordinated door closer and high-quality hinges is of equal importance, because these functional elements of the ECO system also make a decisive contribution towards ensuring that a door can guarantee a safe way out if panic breaks out. Because safety and security are inseparable, ECO Schulte recommends the use of a complete system from a single source.

This ECO panic door combination consists of a fitting, horizontal panic bar, panic switch lock and counterpiece.

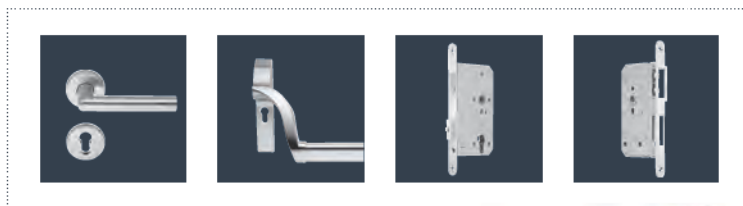

Safety and security are inseparable: only with ECO door closers and ECO hinges is the single source panic door combination complete.



Panic lock functions

A panic lock functions in line with a defined principle: when the handle or panic bar is activated from the inside, the lock must spring open abruptly with a defined amount of force. Not only the latch but, if needed the entire bolt is pulled back here. This basic function can be refined and varied using ECO technology:

Panic Function E – Alternating function

Panic Function E is intended for buildings with access for a defined group of people. A blind plate or knob is mounted on the outside and the door can only be opened with a key. Conventional panic function per handle from the inside.

Area of application: heating room access doors, elevator systems, underground/ multi-storey car parks, storage and commercial buildings, entrance doors in rented apartment complexes and blocks of flats.

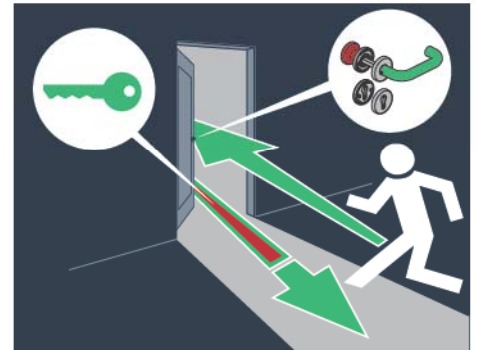

Panic Function D – Transit function

Panic Function D is intended for doors with a pure escape function which are not used otherwise. When the conventional panic function is activated from the inside, the door is opened and the outer handle is engaged as well. In this setting, the door does not constitute an obstacle when entering the building or escaping from it. The original function can be reset with a key. The coupling is mechanical via a two-part hub.

Area of application: escape doors in administration/ office buildings, retirement homes, side entrance doors (e.g. schools and hotels).

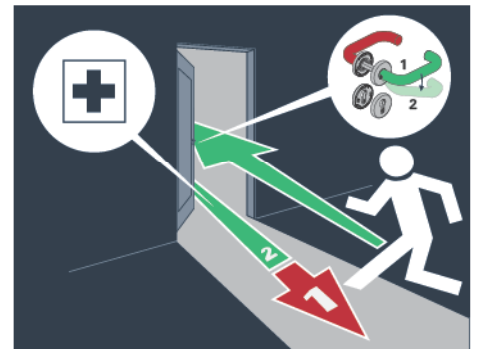

Panic Function B – Switchover function

Panic Function B with a handle on both sides is designed for buildings open to the general public. While the handle on the inside has a conventional panic function, the outside handle can be engaged or disengaged mechanically as required. The two handles are coupled via a two-part hub.

Area of application: escape doors in administration buildings, retirement homes, side entrance doors (e.g. schools and hotels).



Panic Function C – Forced closure function

Panic Function C with a handle on both sides is designed for buildings open to the general public: While the handle on the inside has a conventional panic function, the handle on the outside is disengaged as standard (idle function) and a key position (open position) must be used to engage and disengage it (forced closure). However, the key can only be removed after the idle function has been set again.

Fields of application: doors in administration or office buildings, retirement homes, side entrance doors (schools or hotels)

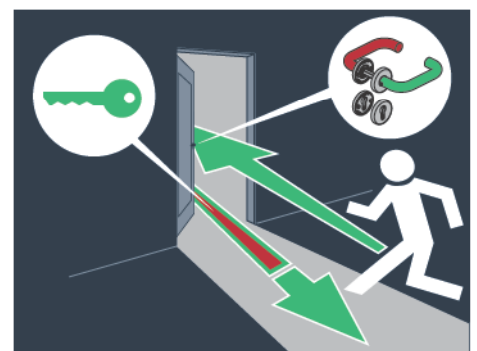

Reliable and precise as clockwork

ECO Schulte can look back on many years of experience in the development and manufacture of locks. ECO Schulte locks provide the highest possible level of security and reliability in all areas and function as precisely as clockwork. Long-lasting functionality and a long service life are guaranteed by state-of-the-art manufacture using high-quality materials and construction measures. As panic locks, ECO locks correspond with horizontal panic triggering elements and conventional ECO fittings in the ideal manner. A defined trigger impulse ensures that the door springs open abruptly.

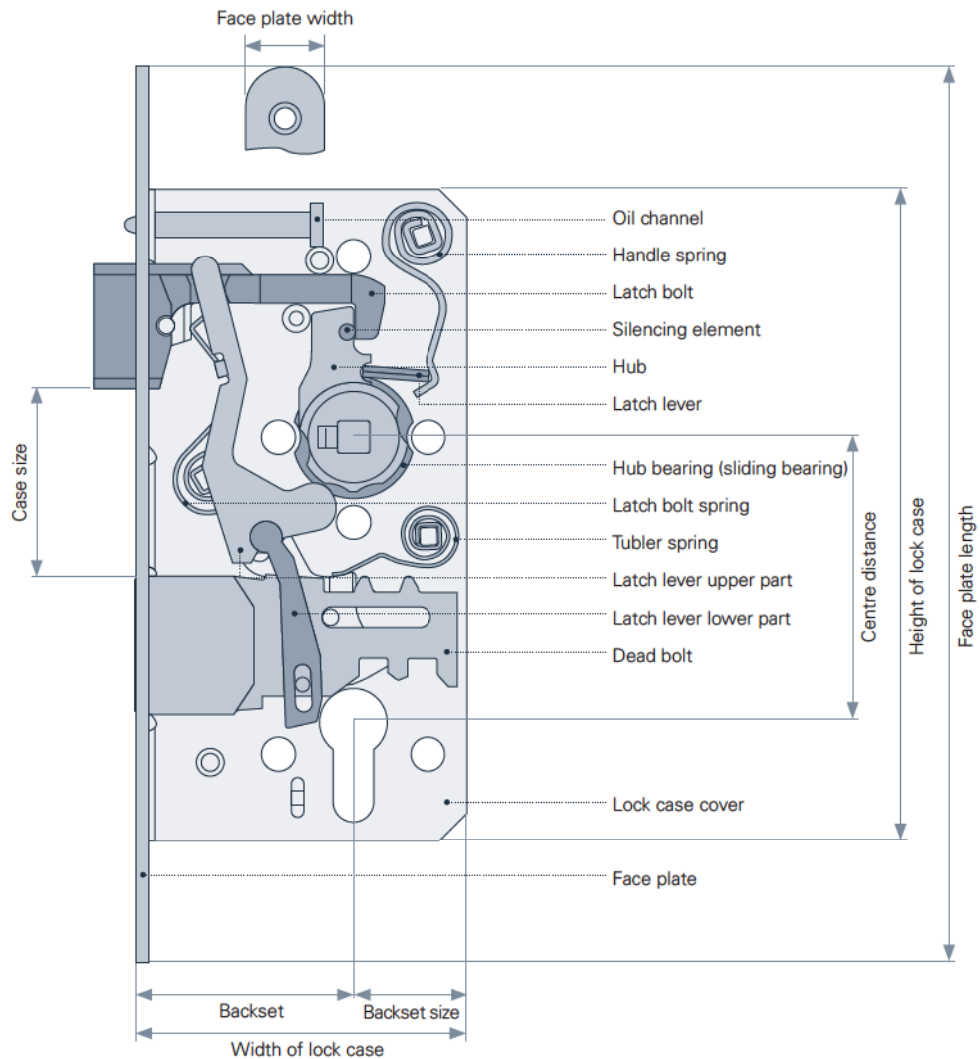

Locks of the very best

Optional silencing

ECO locks have the option of silencing by means of a sound insulating rubber element on the latch bolt. Another ECO speciality is an integrated oil channel that lubricates all of the moving parts of the lock. No additional recesses in the lock pocket are required because all DIN dimensions are complied with.

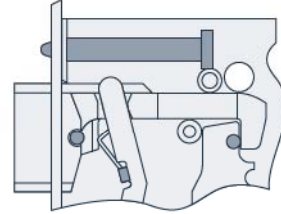

Triple latch bolt

Instead of hitting the strike plate, the ECO triple latch bolt is pressed back into the lock by a lever mechanism. An additional milling groove should be cut in the lock pocket to install the crank latch.

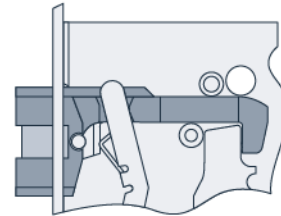

Spring hub

A spring in the handle hub jams the pinion of the handle. This results in the precise guiding of the split spindle and thereby the door handle. Tolerances are compensated. The hub is smoothly mounted in a wear-resistant plastic bearing. ECO mortise locks with sliding bearings provide the best possible ease of operation, even when used intensively.

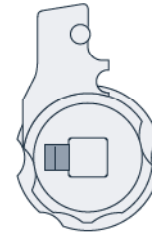

Protection bushings

ECO offers locks with protection bushings fitted in the standard lock attachment drill holes to prevent wood or metal drill shavings from falling into the locking mechanism during assembly and impairing its functionality.

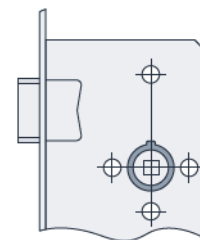

Locks and strike plates for all notch types

Mortise locks with a face plate mounted on one side and angular striking plates are required for rebated doors. A mortise lock with a centred face plate and flat striking plate is required for flush edge doors.



Profile rebated door

Profile unrebated door

Mortise locks left/right

Mortise locks are designated in accordance with **DIN 107** from the side of the door where the hinges are visible. Hinges visible on the left side = DIN left, hinges visible on the right side = DIN right.

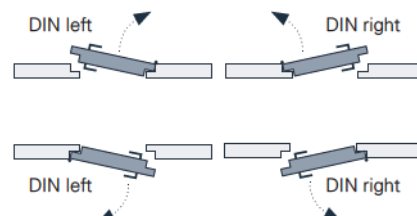

TABLE OF CONTENTS

Panic locks ■ For single-leaf wooden and metal doors



GBS 81



GBS 82



GBS 83



GBS 90



GBS 91



GBS 92

Panic locks ■ For double-leaf wooden and metal doors



GBS 83



GBS 84



GBS 93



GBS 94



GBS 94f

Panic locks ■ For single-leaf profile frame doors



GBS 71



GBS 76



GBS 96

Panic locks ■ For double-leaf profile frame doors



GBS 72
Active leaf



GBS 73
Passive leaf



GBS 76
Page 486



GBS 97
Active leaf



GBS 98
Passive leaf

Mortise locks ■ For wooden doors



GBS 12



GBS 15



GBS 31



GBS 31 C



GBS 31 E



GBS 39

Mortise locks ■ For profile frame doors



GBS 69

Fire-proof mortise locks ■ For wooden and steel doors



GBS 81



GBS 82

Fire-proof mortise locks ■ For single-leaf profile frame doors



GBS 71



GBS 76

ECO lock technology and panic combinations



GBS 12

Product characteristics

Lock type	PZ-72 W (W = handle / knob execution)	■
	BB-72 (Insert)**	□
	WC-78	■
	RZ-74	□
Backset	55, 60, 65	■
Face plate	Stainless steel	■
Face plate width	18	-
	20, 24	■
Hub	8 mm*	■
	9 mm	□

■ Yes - No □ On request *Special spring hub



Steel door



Wooden door

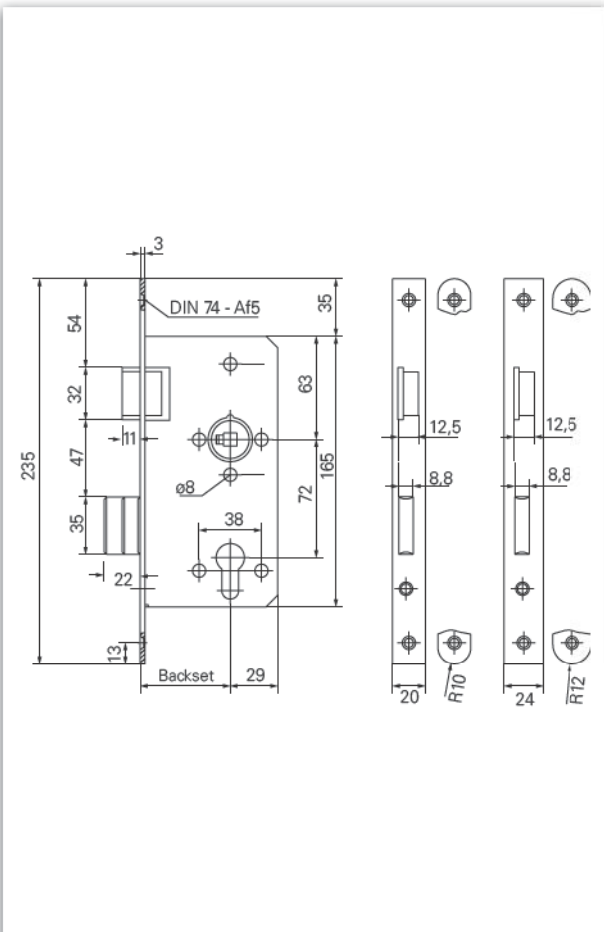

Dimensioning: GBS 12

Description

- With closed lock case with 3-fold fastening.
Lock case zinc-plated
- For interior doors
- Manufactured acc. to **DIN 18251**, class 3
- Dead bolt, nickel-plated, double-turn,
Version WC single-turn
- Hub with spring hub in wear-resistance
sliding bearing
- Latch bolt nickel-plated with silencing elements
- Special version: Triple latch bolt nickel-plated
on request
- Face plate square on request

On request individual plate stamping possible at extra charge.



GBS 12 ■ Mortise lock

Face plate Finish	Backset in mm	Face Plate Form	Face plate 20 x 235 mm PZ-72 (W = handle / knob execution)		Face plate 20 x 235 mm WC-78	
			DIN left	DIN right	DIN left	DIN right
Stainless Steel	55	round	2012A1AL29BDF13	2012A1AL29BDF14	2012A1EL29BDF11	2012A1EL29BDF12
	60	round	2012A1AM29BDF13	2012A1AM29BDF14	2012A1EM29BDF11	2012A1EM29BDF12
	65	round	2012A1AN29BDF13	2012A1AN29BDF14	2012A1EN29BDF11	2012A1EN29BDF12

Face plate Finish	Backset in mm	Face Plate Form	Face plate 24 x 235 mm PZ-72 (W = handle / knob execution)		Face plate 24 x 235 mm WC-78	
			DIN left	DIN right	DIN left	DIN right
Stainless Steel	55	round	2012A1AL29aDF13	2012A1AL29aDF14	2012A1EL29aDF11	2012A1EL29aDF12
	60	round	2012A1AM29aDF13	2012A1AM29aDF14	2012A1EM29aDF11	2012A1EM29aDF12
	65	round	2012A1AN29aDF13	2012A1AN29aDF14	2012A1EN29aDF11	2012A1EN29aDF12
Stainless Steel	55	square	2012A1AL29dDF13	2012A1AL29dDF14	-	-
	60	square	2012A1AM29dDF13	2012A1AM29dDF14	-	-
	65	square	2012A1AN29dDF13	2012A1AN29dDF14	-	-

****Please order the BB-insert separately. You can find the BB-insert on page 367.**



Product characteristics		
Lock type	PZ-72 W (W = handle / knob execution)	■
	BB-72 (Insert)**	□
	WC-78	■
	RZ-74	□
Backset	55, 60, 65	■
Face plate	Stainless steel	■
Face plate width	18	-
	20, 24	■
Hub	8 mm*	■
	9 mm	□
Special version	Triple latch bolt nickel-plated	□
■ Yes - No □ On request *Special spring hub		
 Steel door  Wooden door		

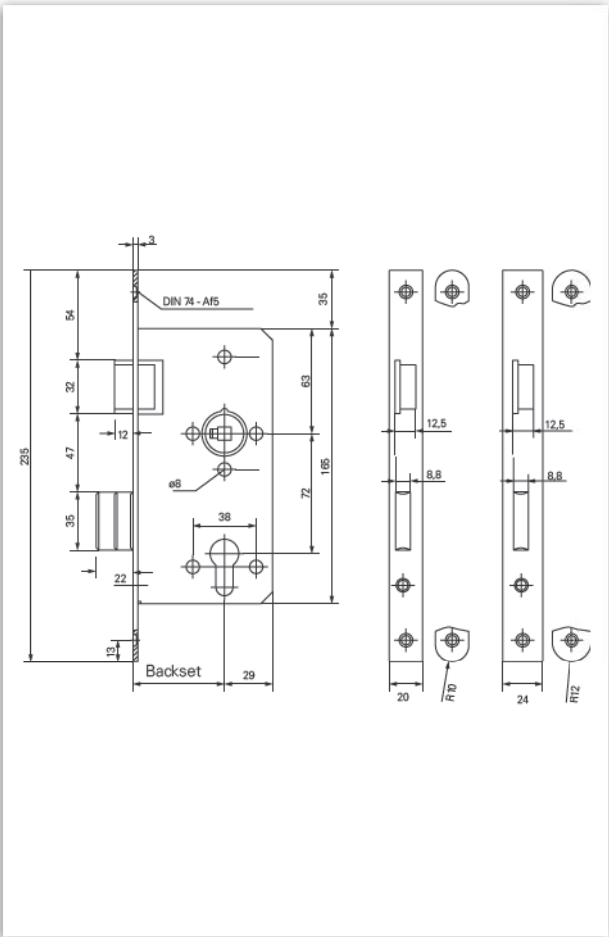

Dimensioning: GBS 15

Description

- With closed lock case with 3-fold fastening. Lock case zinc-plated
- For doors with high frequency
- Manufactured acc. to **DIN 18251**, Klasse 4
- Dead bolt, nickel-plated, double-turn
- Latch bolt nickel-plated with silencing elements
- Hub with spring hub in wear-resistance sliding bearing
- With oil channel
- Special version: Triple latch bolt nickel-plated on request
- Face plate square on request



GBS 15 ■ Mortise lock

Face plate Finish	Backset in mm	Face Plate Form	Face plate 20 x 235 mm PZ-72 (W = handle / knob execution)		Face plate 20 x 235 mm WC-78	
			DIN left	DIN right	DIN left	DIN right
Stainless Steel	55	round	2015A1AL29BDH13	2015A1AL29BDH14	2015A1EL29BDH11	2015A1EL29BDH12
	60	round	2015A1AM29BDH13	2015A1AM29BDH14	2015A1EM29BDH11	2015A1EM29BDH12
	65	round	2015A1AN29BDH13	2015A1AN29BDH14	2015A1EN29BDH11	2015A1EN29BDH12

Face plate Finish	Backset in mm	Face Plate Form	Face plate 24 x 235 mm PZ-72 (W = handle / knob execution)		Face plate 24 x 235 mm WC-78	
			DIN left	DIN right	DIN left	DIN right
Stainless Steel	55	round	2015A1AL29aDH13	2015A1AL29aDH14	2015A1EL29aDH11	2015A1EL29aDH12
	60	round	2015A1AM29aDH13	2015A1AM29aDH14	2015A1EM29aDH11	2015A1EM29aDH12
	65	round	2015A1AN29aDH13	2015A1AN29aDH14	2015A1EN29aDH11	2015A1EN29aDH12

 **Please order the BB-insert separately. You can find the BB-insert on page 367.

GBS 31

Product characteristics		
Lock type	PZ-72 W (W = handle / knob execution)	■
	BB-72	■
	WC-78	■
	RZ-74	■
Backset	45**, 50, 55, 60, 65, 70**	■
	80	□
Face plate	Stainless steel	■
	Polished brass	□
Stulpbreiten	16, 18	-
	20	□
	24	■
Hub	8 mm*	■
	9 mm	□
Special version	Triple latch bolt nickel-plated	□
	Anti thrust latch bolt	□
	Protection bushes	□
	Oil channel	□
DIN left / DIN right useable		■
■ Yes - No □ On request *Special spring hub		
 Steel door  Wooden door		

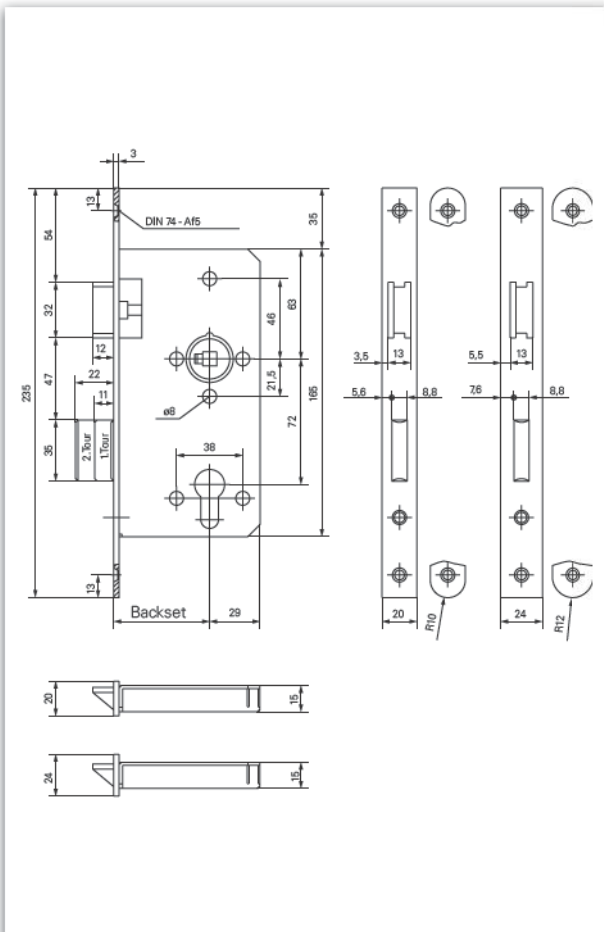

Dimensioning: GBS 31

Description

- With closed lock case with 3-fold fastening. Lock case zinc-plated
- For doors with high frequency
- Manufactured acc. to **DIN 18251**, class 3
- Tested and certified according to **EN 12 209**
- Dead bolt, nickel-plated, double-turn
- Nickel-plated and shiftable latch bolt. Latch bolt can be shifted without opening the lock case. With silencing elements
- Hub with spring hub in wear-resistance sliding bearing
- Fire-proof version on request



On request individual plate stamping possible at extra charge.

****Minimum order quantity: 100 pieces.**

Face plate Finish	Backset in mm	Face Plate Form	Face plate 24 x 235 mm PZ-72 W (W = handle / knob execution)	Face plate 24 x 235 mm BB-72
			DIN left / DIN right	DIN left / DIN right
Stainless Steel	45	round	2231A1045000003	2231A3045000002
	50	round	2231A1050000008	2231A3050000003
	55	round	2231A1055000006	2231A3055000000
	60	round	2231A1060000009	2231A3060000000
	65	round	2231A1065000000	2231A3065000000
	70	round	2231A1070000004	2231A3070000000
Stainless Steel	45	square	2231A1045000002	2231A3045000003
	50	square	2231A1050000002	2231A3050000004
	55	square	2231A1055000003	2231A3055000001
	60	square	2231A1060000008	2231A3060000001
	65	square	2231A1065000002	2231A3065000001
	70	square	2231A1070000003	2231A3070000001

Face plate Finish	Backset in mm	Face Plate Form	Face plate 24 x 235 mm WC-78	Face plate 24 x 235 mm RZ-74 W (W = handle / knob execution)
			DIN left / DIN right	DIN left / DIN right
Stainless Steel	45	round	2231A2045000002	2231A4045000000
	50	round	2231A2050000002	2231A4050000000
	55	round	2231A2055000002	2231A4055000000
	60	round	2231A2060000008	2231A4060000000
	65	round	2231A2065000000	2231A4065000000
	70	round	2231A2070000000	2231A4070000001
Stainless Steel	45	square	2231A2045000003	2231A4045000001
	50	square	2231A2050000003	2231A4050000001
	55	square	2231A2055000003	2231A4055000001
	60	square	2231A2060000009	2231A4060000001
	65	square	2231A2065000001	2231A4065000001
	70	square	2231A2070000001	2231A4070000002

GBS 31 C

Product characteristics		
Backset	45**, 50, 55, 60, 65, 70**	■
	80	□
Face plate	Stainless steel	■
Stulpbreiten	16, 18	-
	20	□
	24	■
Hub	8 mm*	■
	9 mm	□
Special version	Triple latch bolt nickel-plated	□
	Anti thrust latch bolt	□
	Protection bushes	□
	Oil channel	□
DIN left / DIN right useable		■
■ Yes - No □ On request *Special spring hub		
 Steel door  Wooden door		

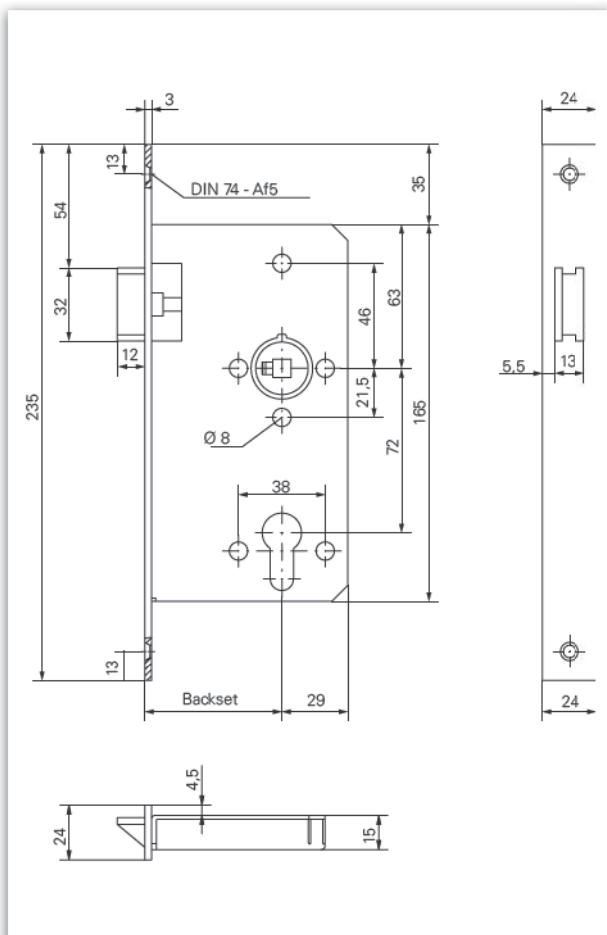

Dimensioning: GBS 31 C

Description

- With closed lock case with 3-fold fastening. Lock case zinc-plated
- For doors with high frequency
- Manufactured acc. to **DIN 18251**, class 3
- Tested and certified according to **EN 12 209**
- Nickel-plated and shiftable latch bolt. Latch bolt can be shifted without opening the lock case. With silencing elements
- Hub with spring hub in wear-resistance sliding bearing
- Fire-proof version on request



On request individual plate stamping possible at extra charge.

****Minimum order quantity: 100 pieces.**

**GBS 31 C ■ Latch bolt lock**

Face plate Finish	Backset in mm	Face Plate Form	Face plate 24 x 235 mm PZ-72 W (W = handle / knob execution) DIN left / DIN right
Stainless Steel	45	round	2231C1045000000
	50	round	2231C1050000000
	55	round	2231C1055000002
	60	round	2231C1060000002
	65	round	2231C1065000000
	70	round	2231C1070000000
Stainless Steel	45	square	2231C1045000001
	50	square	2231C1050000001
	55	square	2231C1055000003
	60	square	2231C1060000003
	65	square	2231C1065000001
	70	square	2231C1070000001

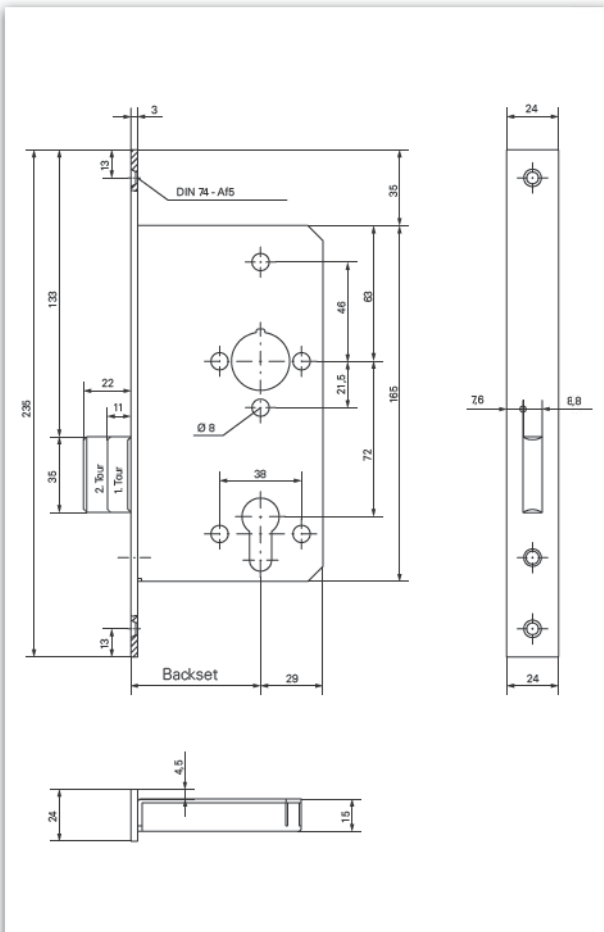

Product characteristics		
Lock type	PZ W (W = handle / knob execution)	■
Backset	45**, 50, 55, 60, 65, 70**	■
	80	□
Face plate	Stainless steel	■
Stulpbreiten	16, 18	-
	20	□
	24	■
Special version	Protection bushes	□
	Oil channel	□
DIN left / DIN right useable		■
■ Yes - No □ On request *Special spring hub		
 Steel door  Wooden door		

Description

- With closed lock case with 3-fold fastening. Lock case zinc-plated
- For doors with high frequency
- Manufactured acc. to **DIN 18251**, class 3
- Tested and certified according to **EN 12 209**
- Dead bolt, nickel-plated, double-turn
- Fire-proof version on request

On request individual plate stamping possible at extra charge.

**Minimum order quantity: 100 pieces.



**GBS 31 E ■ Dead bolt lock**

Face plate Finish	Backset in mm	Face Plate Form	Face plate 24 x 235 mm PZ-72 W (W = handle / knob execution) DIN left / DIN right
Stainless Steel	45	round	2231E1045000000
	50	round	2231E1050000000
	55	round	2231E1055000002
	60	round	2231E1060000002
	65	round	2231E1065000000
	70	round	2231E1070000000
Stainless Steel	45	square	2231E1045000001
	50	square	2231E1050000001
	55	square	2231E1055000003
	60	square	2231E1060000003
	65	square	2231E1065000001
	70	square	2231E1070000001



Product characteristics		
Lock type	PZ-78 W (W = handle / knob execution)	■
	BB-78	■
	WC-78	■
	RZ-78 W (W = handle / knob execution)	■
Backset	60	■
Face plate	Stainless steel finish	■
Face plate width	18	■
Hub	8 mm*	■
	9 mm	□
■ Yes - No □ On request *Special spring hub		
 Wooden door		

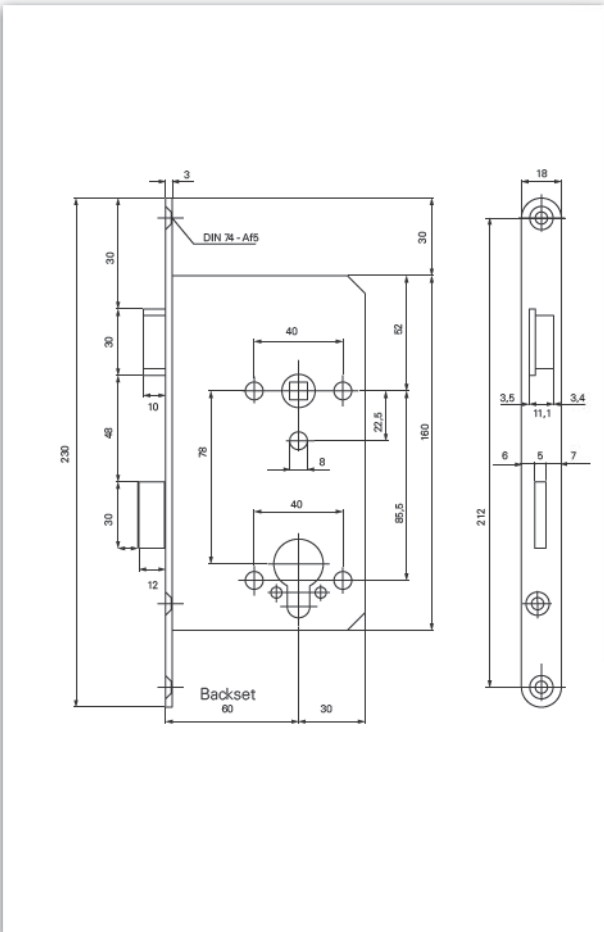

Description

- Mortise lock (Swiss dimensions)
- Dead bolt zinc-plated, single-turn
- Latch bolt with steel delrin
- Zinc-plated lock case

On request individual plate stamping possible at extra charge.

Dimensioning: GBS 39

GBS 39 ■ Mortise lock

Face plate Finish	Hub	Backset in mm	Face Plate Form	Face plate 18 x 230 mm PZ-78 W (W = handle / knob execution)		Face plate 18 x 230 mm RZ-78 W (W = handle / knob execution)	
				DIN left	DIN right	DIN left	DIN right
Stainless Steel	8	60	round	2039aig01u30107	2039aig01u30207	2039aih01u30107	2039aih01u30207

Face plate Finish	Hub	Backset in mm	Face Plate Form	Face plate 18 x 230 mm BB-78		Face plate 18 x 230 mm WC-78	
				DIN left	DIN right	DIN left	DIN right
Stainless Steel	8	60	round	2039aic01u30107	2039aic01u30207	2039aif01u30107	2039aif01u30207

**GBS 69 ■ Mortise lock for profile frame doors**

Face plate Finish	Backset in mm	Face Plate Form	Face plate 24 x 245 mm DIN left / DIN right
Stainless Steel	25	square	2069A1aE28fK017
	30	square	2069A1aG28fK017
	35	square	2069A1aH28fK017
	40	square	2069A1aI28fK017
	45	square	2069A1aJ28fK017

Face plate Finish	Backset in mm	Face Plate Form	Face plate 24 x 245 mm DIN left / DIN right
Steel zinc-plated	25	square	2069A1aE28fJ017
	30	square	2069A1aG28fJ017
	35	square	2069A1aH28fJ017
	40	square	2069A1aI28fJ017
	45	square	2069A1aJ28fJ017



Product characteristics		
Lock type	PZ-92 W (W = handle / knob execution)	■
	RZ-94 W (W = handle / knob execution)	□
Backset	25, 30, 35, 40, 45	■
Panic function	B	■
	E	■
Face plate	Stainless steel	■
Face plate width	24	■
Face plate length	245 mm	■
	400 mm	■
Hub	9 mm	■
Suitable for the use on fire- and smoke control doors	F	■

■ Yes - No □ On request

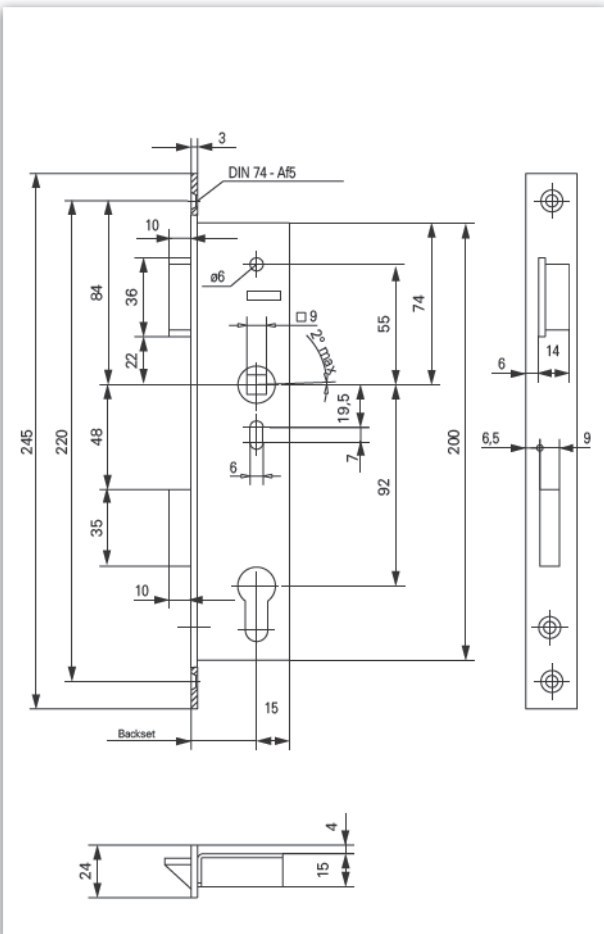
 Profile frame door

Dimensioning: GBS 71

Description

- Mortise lock for single-leaf profile frame doors
- Suitable for fire- and emergency exit doors
- Made completely of fire-resistant materials
- Special version: Dead bolt and latch bolt 3 mm or 5 mm projected
- Single-turn dead bolt

On request individual plate stamping possible at extra charge.

GBS 71 ■ Mortise lock for profile frame doors ■ For fire-and emergency exit doors

Face plate Finish	Backset in mm	Face Plate Form	Face plate 24 x 245 mm PZ-92 W (W = handle / knob execution)		Face plate 24 x 400 mm PZ-92 W (W = handle / knob execution)	
			DIN left	DIN right	DIN left	DIN right
			Stainless Steel	25	square	2071A2aE40fT013
30	square	2071A2aG40fT013		2071A2aG40fT014	2071A2aG40kT013	2071A2aG40kT014
35	square	2071A2aH40fT013		2071A2aH40fT014	2071A2aH40kT013	2071A2aH40kT014
40	square	2071A2aI40fT013		2071A2aI40fT014	2071A2aI40kT013	2071A2aI40kT014
45	square	2071A2aJ40fT013		2071A2aJ40fT014	2071A2aJ40kT013	2071A2aJ40kT014

Face plate Finish	Backset in mm	Face Plate Form	Face plate 24 x 245 mm Function B / PZ-92		Face plate 24 x 400 mm Function B / PZ-92	
			DIN left	DIN right	DIN left	DIN right
			Stainless Steel	25	square	2071A2aE40fTP11
30	square	2071A2aG40fTP11		2071A2aG40fTP12	2071A2aG40kTP11	2071A2aG40kTP12
35	square	2071A2aH40fTP11		2071A2aH40fTP12	2071A2aH40kTP11	2071A2aH40kTP12
40	square	2071A2aI40fTP11		2071A2aI40fTP12	2071A2aI40kTP11	2071A2aI40kTP12
45	square	2071A2aJ40fTP11		2071A2aJ40fTP12	2071A2aJ40kTP11	2071A2aJ40kTP12

Face plate Finish	Backset in mm	Face Plate Form	Face plate 24 x 245 mm Function E / PZ-92 W (W = handle / knob execution)		Face plate 24 x 400 mm Function E / PZ-92 W (W = handle / knob execution)	
			DIN left	DIN right	DIN left	DIN right
			Stainless Steel	25	square	2071A2aE40fTQ13
30	square	2071A2aG40fTQ13		2071A2aG40fTQ14	2071A2aG40kTQ13	2071A2aG40kTQ14
35	square	2071A2aH40fTQ13		2071A2aH40fTQ14	2071A2aH40kTQ13	2071A2aH40kTQ14
40	square	2071A2aI40fTQ13		2071A2aI40fTQ14	2071A2aI40kTQ13	2071A2aI40kTQ14
45	square	2071A2aJ40fTQ13		2071A2aJ40fTQ14	2071A2aJ40kTQ13	2071A2aJ40kTQ14



Product characteristics		
Lock type	PZ-92 W (W = handle / knob execution)	■
	RZ-94 W (W = handle / knob execution)	□
Backset	25, 30, 35, 40, 45	■
Panic function	B	■
	E	■
Face plate	Stainless steel	■
Face plate width	24	■
Hub	9 mm	■
Suitable for the use on fire- and smoke control doors	F	■

■ Yes - No □ On request

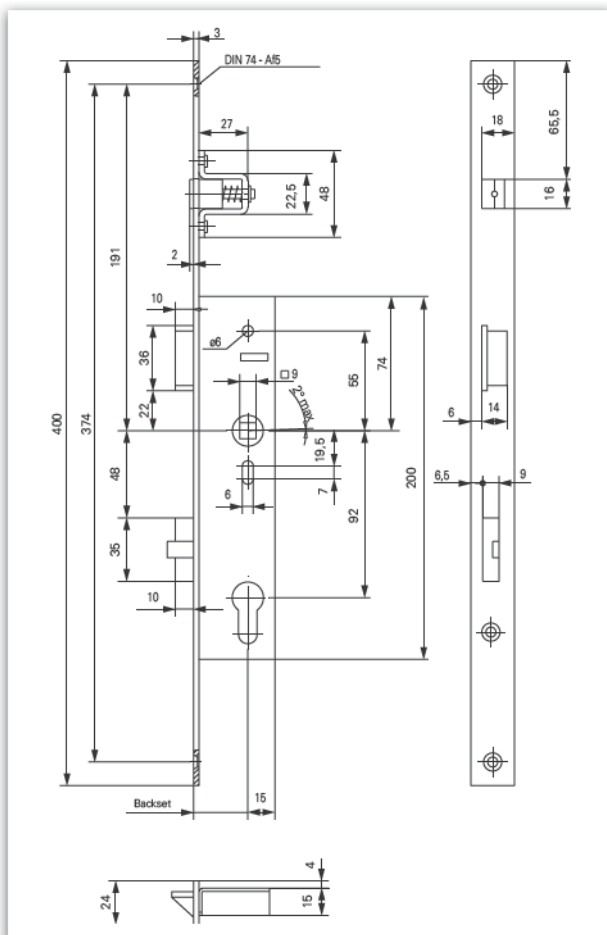
 Profile frame door

Description

- Mortise lock for double-leaf profile frame doors
- Suitable for fire- and emergency exit doors
- Made completely of fire-resistant materials
- Special version: Dead bolt and latch bolt 3 mm or 5 mm projected
- Single-turn dead bolt
- Special feature: Adjustable release device for automatically locking the inactive door leaf.
- Related counter lock for passive leaf: GBS 73 on page 484.

On request individual plate stamping possible at extra charge.

Dimensioning: GBS 72

GBS 72 ■ Mortise lock for profile frame doors ■ For fire-and emergency exit doors

Face plate Finish	Backset in mm	Face Plate Form	Face plate 24 x 400 mm PZ-92 W (W = handle / knob execution)	
			DIN left	DIN right
Stainless Steel	25	square	2072A2aE40kT013	2072A2aE40kT014
	30	square	2072A2aG40kT013	2072A2aG40kT014
	35	square	2072A2aH40kT013	2072A2aH40kT014
	40	square	2072A2aI40kT013	2072A2aI40kT014
	45	square	2072A2aJ40kT013	2072A2aJ40kT014

Face plate Finish	Backset in mm	Face Plate Form	Face plate 24 x 400 mm Function B / PZ-92	
			DIN left	DIN right
Stainless Steel	25	square	2072A2aE40kTP11	2072A2aE40kTP12
	30	square	2072A2aG40kTP11	2072A2aG40kTP12
	35	square	2072A2aH40kTP11	2072A2aH40kTP12
	40	square	2072A2aI40kTP11	2072A2aI40kTP12
	45	square	2072A2aJ40kTP11	2072A2aJ40kTP12

Face plate Finish	Backset in mm	Face Plate Form	Face plate 24 x 400 mm Function E / PZ-92 W (W = handle / knob execution)	
			DIN left	DIN right
Stainless Steel	25	square	2072A2aE40kTQ13	2072A2aE40kTQ14
	30	square	2072A2aG40kTQ13	2072A2aG40kTQ14
	35	square	2072A2aH40kTQ13	2072A2aH40kTQ14
	40	square	2072A2aI40kTQ13	2072A2aI40kTQ14
	45	square	2072A2aJ40kTQ13	2072A2aJ40kTQ14

GBS 73 ■ Mortise lock for profile frame doors ■ For fire-and emergency exit doors

Face plate Finish	Backset in mm	Face Plate Form	Face plate 24 x 400 mm Panic function with automatic locking device for inactive door leaf	
			DIN left	DIN right
Stainless Steel	25	square	2073X00E40kTM11	2073X00E40kTM12
	30	square	2073X00G40kTM11	2073X00G40kTM12
	35	square	2073X00H40kTM11	2073X00H40kTM12
	40	square	2073X00I40kTM11	2073X00I40kTM12
	45	square	2073X00J40kTM11	2073X00J40kTM12

Face plate Finish	Backset in mm	Face Plate Form	Face plate 24 x 400 mm Panic function with manual locking device for inactive door leaf	
			DIN left	DIN right
Stainless Steel	25	square	2073Y00E40kTM11	2073Y00E40kTM12
	30	square	2073Y00G40kTM11	2073Y00G40kTM12
	35	square	2073Y00H40kTM11	2073Y00H40kTM12
	40	square	2073Y00I40kTM11	2073Y00I40kTM12
	45	square	2073Y00J40kTM11	2073Y00J40kTM12



Product characteristics		
Lock type	PZ-92 W (W = handle / knob execution)	■
	RZ-74 W (W = handle / knob execution)	□
Backset	25, 30, 35, 40, 45	■
Panic function	B	■
	E	■
	without*	□
Face plate	Stainless steel	■
Face plate width	24	■
Hub	9 mm	■
Suitable for the use on fire- and smoke control doors	F	■

■ Yes - No □ On request *With free-running hub

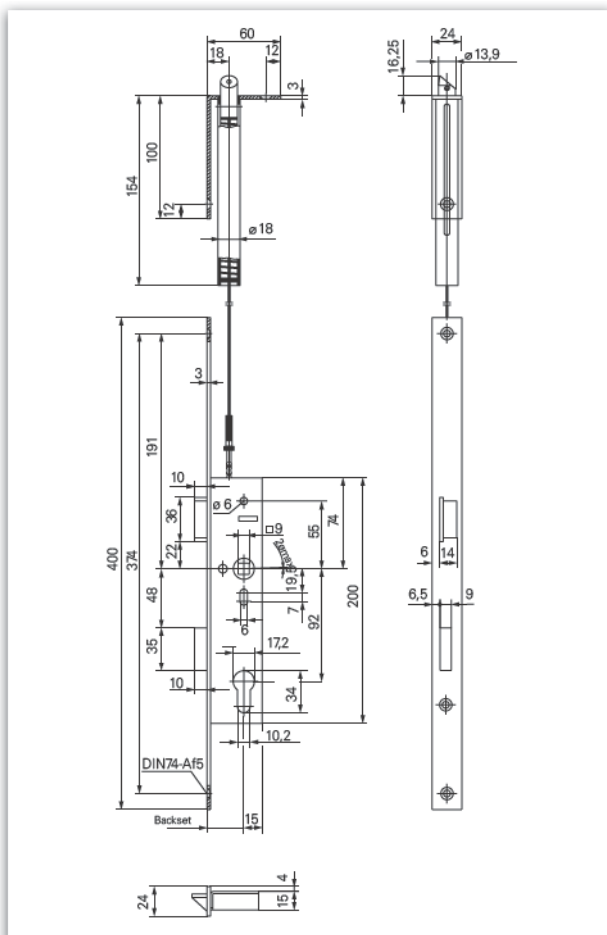
 Profile frame door

Dimensioning: GBS 76

Description

- Mortise lock for single or double-leaf fire-proof doors
- Suitable for fire- and emergency exit doors
- Made completely of fire-resistant materials
- Dead bolt and latch bolt flush or 3 mm or 5 mm projected
- Adjustable, with top corner latch-lock as additional locking point. Corner latch lock can also be used independently from the lock
- Corner angle manual on request

On request individual plate stamping possible at extra charge.

GBS 76 ■ Mortise lock for single or double-leaf fire-proof doors

Face plate Finish	Backset in mm	Face Plate Form	Face plate 24 x 400 mm PZ-92 W (W = handle / knob execution)		Face plate 24 x 400 mm PZ-92 W (W = handle / knob execution) / With free-running hub (use in double-leaf doors without panic function)	
			DIN left	DIN right	DIN left	DIN right
Stainless Steel	25	square	2076A2aE40kT0U3	2076A2aE40kT0U4	2076A2aE80kT0U3	2076A2aE80kT0U4
	30	square	2076A2aG40kT0U3	2076A2aG40kT0U4	2076A2aG80kT0U3	2076A2aG80kT0U4
	35	square	2076A2aH40kT0U3	2076A2aH40kT0U4	2076A2aH80kT0U3	2076A2aH80kT0U4
	40	square	2076A2aI40kT0U3	2076A2aI40kT0U4	2076A2aI80kT0U3	2076A2aI80kT0U4
	45	square	2076A2aJ40kT0U3	2076A2aJ40kT0U4	2076A2aJ80kT0U3	2076A2aJ80kT0U4

Face plate Finish	Backset in mm	Face Plate Form	Face plate 24 x 400 mm Function B / PZ-92	
			DIN left	DIN right
Stainless Steel	25	square	2076A2aE40kTPU1	2076A2aE40kTPU2
	30	square	2076A2aG40kTPU1	2076A2aG40kTPU2
	35	square	2076A2aH40kTPU1	2076A2aH40kTPU2
	40	square	2076A2aI40kTPU1	2076A2aI40kTPU2
	45	square	2076A2aJ40kTPU1	2076A2aJ40kTPU2

Face plate Finish	Backset in mm	Face Plate Form	Face plate 24 x 400 mm Function E / PZ-92 W (W = handle / knob execution)	
			DIN left	DIN right
Stainless Steel	25	square	2076A2aE40kTQU3	2076A2aE40kTQU4
	30	square	2076A2aG40kTQU3	2076A2aG40kTQU4
	35	square	2076A2aH40kTQU3	2076A2aH40kTQU4
	40	square	2076A2aI40kTQU3	2076A2aI40kTQU4
	45	square	2076A2aJ40kTQU3	2076A2aJ40kTQU4

GBS 81 ■ Mortise lock for fire-proof doors
DIN 18 250
EN 12 209
F

Face plate Finish	Backset in mm	Face Plate Form	Face plate 20 x 235 mm PZ-72 W (W = handle / knob execution)		Face plate 24 x 235 mm PZ-72 W (W = handle / knob execution)	
			DIN left	DIN right	DIN left	DIN right
Stainless Steel satin	55	round	2081_2AL40BK013	2081_2AL40BK014	2081_2AL40aK013	2081_2AL40aK014
	65	round	2081_2AN40BK013	2081_2AN40BK014	2081_2AN40aK013	2081_2AN40aK014
Steel zinc-plated	55	round	2081_2AL40BJ013	2081_2AL40BJ014	2081_2AL40aJ013	2081_2AL40aJ014
	65	round	2081_2AN40BJ013	2081_2AN40BJ014	2081_2AN40aJ013	2081_2AN40aJ014

GBS 82

Product characteristics

Lock type	PZ-72W (W = handle / knob execution)	■
Backset	65	■
Panic function	D	■
	E	■
Face plate	Steel zinc-plated	■
Face plate width	24	■
Hub	9 mm	■
Suitable for the use on fire- and smoke control doors	F	■
Tested acc. EN / DIN	EN 179	
DIN left / DIN right useable		■

■ Yes - No □ On request

Description

- Mortise lock for fire-proof doors
- Suitable for fire- and emergency exit doors
- Tested and certified acc. to **EN 179**
- Made completely of fire-resistant materials

On request individual plate stamping possible at extra charge.

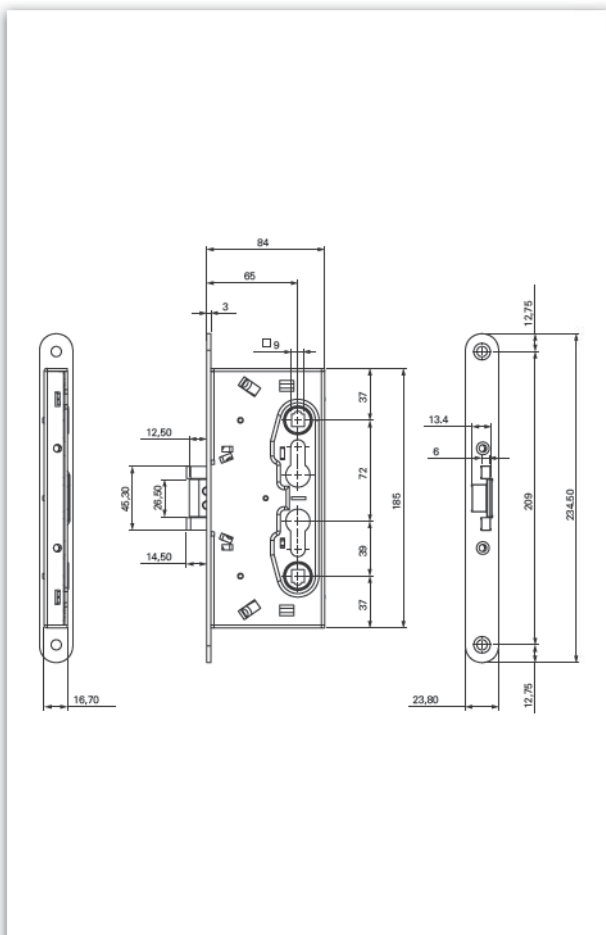

Dimensioning: GBS 82

GBS 82 ■ Mortise lock for fire-proof doors
DIN 18 250
F

Face plate Finish	Backset in mm	Face Plate Form	Face plate 24 x 235 mm PZ-72 W (W = handle / knob execution) DIN left / DIN right
Steel zinc-plated	65	round	2082aja02m10000



EN 179
EN 1125
F

Face plate Finish	Backset in mm	Face Plate Form	Face plate 24 x 235 mm Function D / PZ-72 DIN left / DIN right
Steel zinc-plated	65	round	2082aja02m13000

EN 179
EN 1125
F

Face plate Finish	Backset in mm	Face Plate Form	Face plate 24 x 235 mm Function E / PZ-72 W (W = handle / knob execution) DIN left / DIN right
Steel zinc-plated	65	round	2082aja02m14000

GBS 83

Product characteristics		
Lock type	PZ-72	■
Backset	65	■
Panic function	B	■
Face plate	Steel zinc-plated	■
Face plate width	24	■
Hub	9 mm	■
Suitable for the use on fire- and smoke control doors	F	■
Tested acc. EN / DIN	EN 179  EN 1125 	
DIN left / DIN right useable		■
■ Yes - No □ On request		
 Steel door		

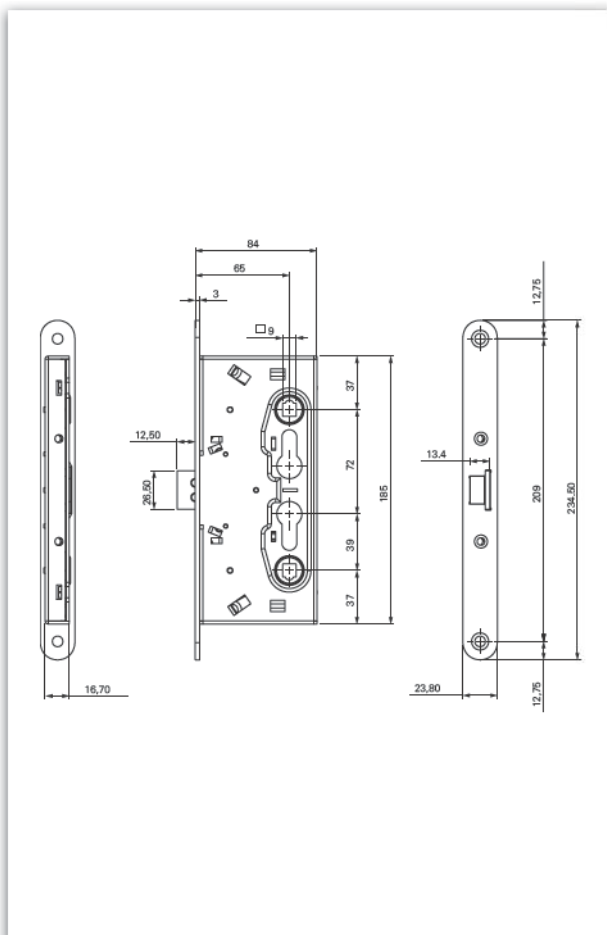



Dimensioning: GBS 83

Description

- Mortise lock for fire proof doors
- Suitable for fire- and emergency exit doors
- Tested and certified acc. to **EN 179** and **EN 1125**
- Made completely of fire-resistant materials

On request individual plate stamping possible at extra charge.

Face plate Finish	Backset in mm	Face plate	Face plate 24 x 235 mm Function B / PZ-72 DIN left / DIN right
Steel zinc-plated	65	round	2083aja02m13000

Product characteristics		
Backset	65	■
Face plate	Steel zinc-plated	■
Face plate width	24	■
Hub	9 mm	■
Suitable for the use on fire- and smoke control doors	F	■
Tested acc. EN / DIN	EN 179  EN 1125 	
DIN left / DIN right useable		■
■ Yes - No □ On request		



Description

- Counter lock for fire proof doors
- Suitable for fire- and emergency exit doors
- Tested and certified acc. to **EN 179** and **EN 1125**
- Made completely of fire-resistant materials
- Can also be used as manual rebate dead bolt lock (without handle set)

On request individual plate stamping possible at extra charge.

Counter lock

Face plate Finish	Backset in mm	Face plate	Face plate 24 x 235 mm DIN left / DIN right
Steel zinc-plated	65	round	2084aj002m11000

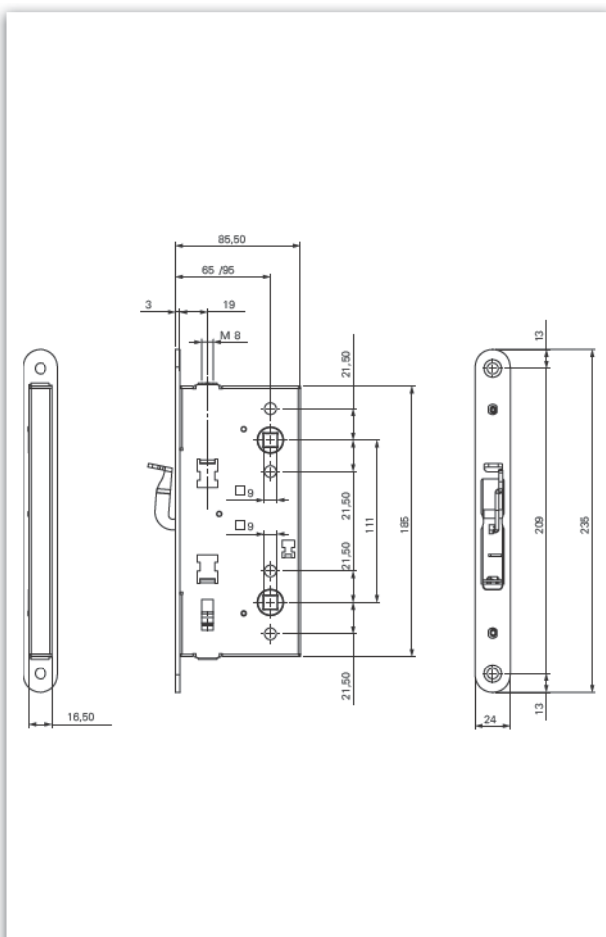

Dimensioning: GBS 84



Product characteristics		
Lock type	PZ-72 W (W = handle / knob execution)	■
	RZ-74 W (W = handle / knob execution)	□
Backset	55, 65	■
Face plate	Stainless steel	■
Face plate width	20, 24	■
Hub	9 mm	■
Suitable for the use on fire- and smoke control doors	F	■
Tested acc. EN / DIN	DIN 18 250 EN 12 209	
■ Yes - No □ On request		
 Steel door  Wooden door		

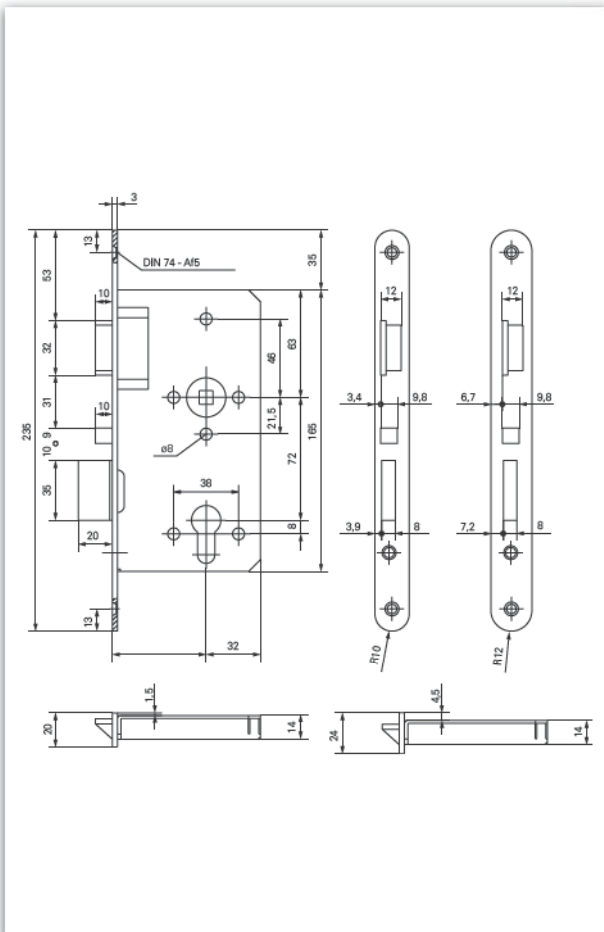

Dimensioning: GBS 90

Description
GBS 90 / GBS 90 F

- Automatic self-engaging panic mortise lock with panic function
- With closed locke case with 3-fold fastening with protection bushes
- Stainless steel dead and latch bolt
- Tested and certified acc. to **DIN 18250, EN 12 209**
- Automatic locking is effected by closing and consequently engaging the auxilliary latch

On request individual plate stamping possible at extra charge.

GBS 90 ■ Automatic self-engaging panic mortise lock (AVP)
GBS 90 **DIN 18 250**

Face plate Finish	Backset in mm	Face Plate Form	Face plate 20 x 235 mm PZ-72 W (W = handle / knob execution)		Face plate 24 x 235 mm PZ-72 W (W = handle / knob execution)	
			DIN left	DIN right	DIN left	DIN right
Stainless Steel	55	round	2090aha02h30300	2090aha02h30400	2090aha02m30300	2090aha02m30400
	65	round	2090aja02h30300	2090aja02h30400	2090aja02m30300	2090aja02m30400

GBS 90 F **DIN 18 250** **F**

Face plate Finish	Backset in mm	Face Plate Form	Face plate 20 x 235 mm PZ-72 W (W = handle / knob execution)		Face plate 24 x 235 mm PZ-72 W (W = handle / knob execution)	
			DIN left	DIN right	DIN left	DIN right
Stainless Steel	55	round	2090aha08h30300	2090aha08h30400	2090aha08m30300	2090aha08m30400
	65	round	2090aja08h30300	2090aja08h30400	2090aja08m30300	2090aja08m30400

Special functions

02 / Monitored dead bolt

03 / Blocked handle on both sides, fail safe

04 / Blocked handle on both sides, fail secure

05 / Handle one side blocked, fail safe, B* or G*

06 / Handle one side blocked, fail secure, B* or G*

08 / 24-V version

Micro switch

Gold-plated contacts | max. 15V - 200 mA

Dead bolt off | Closer

Dead bolt on | Closer

Degree of protection | IP 40

Connection

 Flexible cable, provided by customer, max. cable diameter 1,5 mm²
Blocking magnet, divided hub

Nominal voltage | 12V-

Supply voltage | 10,5V- bis 14V-

Maximum rated input power | 100 mA at 12V- = 1,2W





Rel. duty cycle ED | 100 %

Class of insulation | E (T-grenz = 1,2W)

B* = Hinge side

G* = Hinge opposite side



Product characteristics		
Lock type	PZ-72 W (W = handle / knob execution)	■
	RZ-74 W (W = handle / knob execution)	□
Backset	55, 65	■
Face plate	Stainless steel	■
Face plate width	20, 24	■
Hub	9 mm	■
Suitable for the use on fire- and smoke control doors	F	■
Tested acc. EN / DIN	EN 179  EN 1125 	
	EN 12 209	
<p>■ Yes - No □ On request</p>		
<p> Steel door  Wooden door</p>		

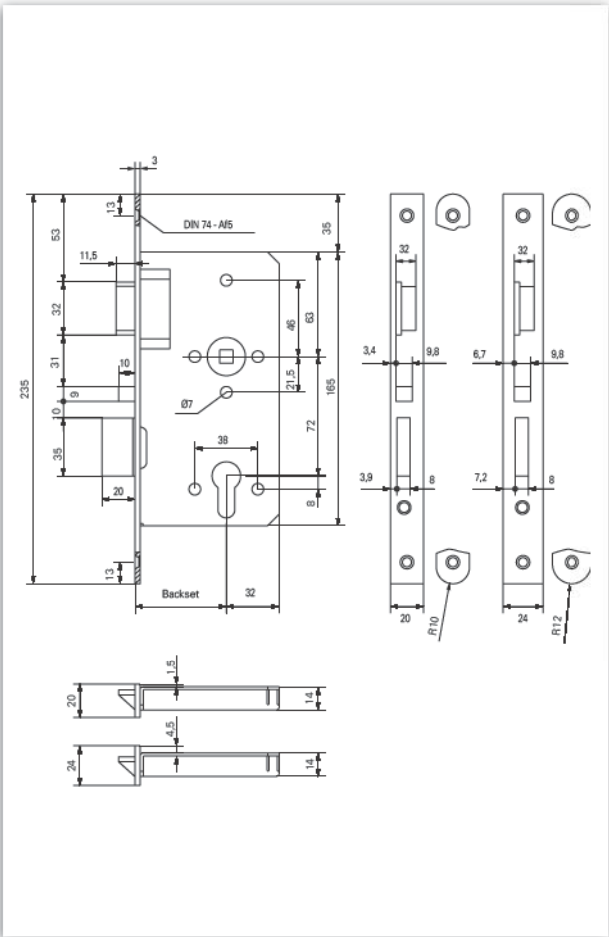

Dimensioning: GBS 91

Description

- Automatic self-engaging panic mortise lock
- Suitable for fire-protection doors
- Tested and certified acc. to **EN 179, EN 1125 and EN 12 209**
- Made completely of fire-resistant materials
- Extras: Handle locking and interrogation of dead bolt position

On request individual plate stamping possible at extra charge.

**GBS 91 ■ Automatic self-engaging panic mortise lock (AVP) for fire proof doors**

Face plate Finish	Backset in mm	Face Plate Form	Face plate 20 x 235 mm PZ-72 W (W = handle / knob execution)		Face plate 24 x 235 mm PZ-72 W (W = handle / knob execution)	
			DIN left	DIN right	DIN left	DIN right
Stainless Steel	55	round	2091aha02h30300	2091aha02h30400	2091aha02m30300	2091aha02m30400
	65	round	2091aja02h30300	2091aja02h30400	2091aja02m30300	2091aja02m30400



Product characteristics		
Lock type	PZ-72	■
	RZ-74	■
Backset	55, 65, 80	■
Panic funktion	B B - inward	■
	C C - inward	■
	D D - inward	■
	E -	■
Face plate	Stainless steel	■
Face plate width	20, 24	■
Hub	9 mm	■
Suitable for the use on fire- and smoke control doors	F	■
Tested acc. EN / DIN	<div style="display: flex; gap: 5px;"> <div style="border: 1px solid black; padding: 2px;">EN 179 </div> <div style="border: 1px solid black; padding: 2px;">EN 1125 </div> </div> <div style="display: flex; gap: 5px; margin-top: 5px;"> <div style="border: 1px solid black; padding: 2px;">DIN 18 250</div> <div style="border: 1px solid black; padding: 2px;">EN 12 209</div> </div>	
<input checked="" type="checkbox"/> Yes - No <input type="checkbox"/> On request		
<div style="display: flex; justify-content: space-around; align-items: center;"> <div style="text-align: center;"> <p>Steel door</p> </div> <div style="text-align: center;"> <p>Wooden door</p> </div> </div>		

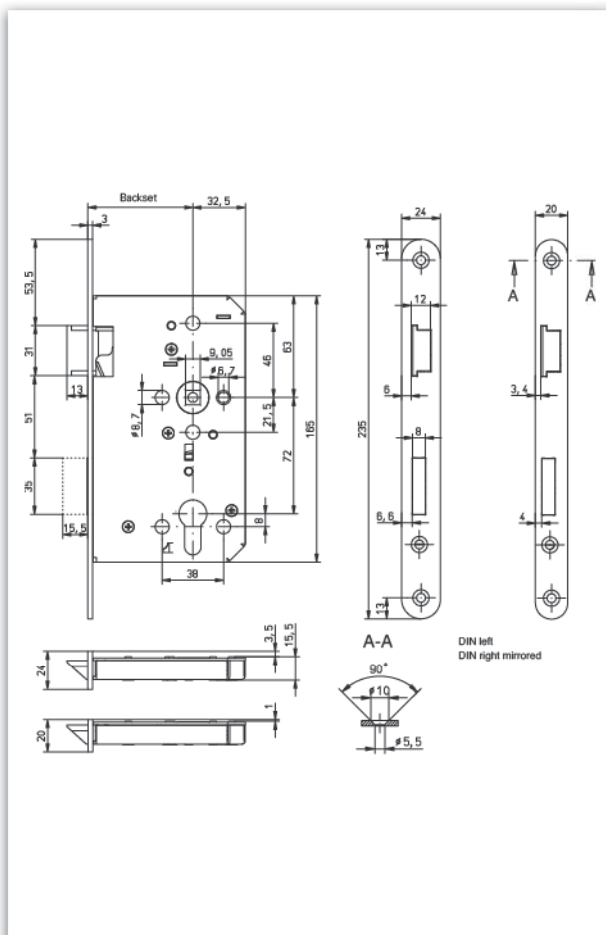

Dimensioning: GBS 92

Description

- Panic mortise lock
- Tested and certified acc. to **EN 179, EN 1125, DIN 18 250** and **EN 12 209**
- For single-leaf wooden and steeldoors as well as fire-protection doors
- Face plate square on request

On request individual plate stamping possible at extra charge.

GBS 92 ■ Panic mortise lock for fire-proof doors

Face plate Finish	Backset in mm	Face Plate Form	Face plate 20 x 235 mm Function B single-leaf / PZ-72		Face plate 20 x 235 mm Function C single-leaf / PZ-72	
			DIN left	DIN right	DIN left	DIN right
Stainless Steel	55	round	2092_ha02h33100	2092_ha02h33200	2092_ha02h32100	2092_ha02h32200
	65	round	2092_ja02h33100	2092_ja02h33200	2092_ja02h32100	2092_ja02h32200
	80	round	2092_ma02h33100	2092_ma02h33200	2092_ma02h32100	2092_ma02h32200

Face plate Finish	Backset in mm	Face Plate Form	Face plate 20 x 235 mm Function D single-leaf / PZ-72		Face plate 20 x 235 mm Function E single-leaf / PZ-72	
			DIN left	DIN right	DIN left	DIN right
Stainless Steel	55	round	2092_ha02h35100	2092_ha02h35200	2092_ha02h34100	2092_ha02h34200
	65	round	2092_ja02h35100	2092_ja02h35200	2092_ja02h34100	2092_ja02h34200
	80	round	2092_ma02h35100	2092_ma02h35200	2092_ma02h34100	2092_ma02h34200

Face plate Finish	Backset in mm	Face Plate Form	Face plate 24 x 235 mm Function B single-leaf / PZ-72		Face plate 24 x 235 mm Function C single-leaf / PZ-72	
			DIN left	DIN right	DIN left	DIN right
Stainless Steel	55	round	2092_ha02m33100	2092_ha02m33200	2092_ha02m32100	2092_ha02m32200
	65	round	2092_ja02m33100	2092_ja02m33200	2092_ja02m32100	2092_ja02m32200
	80	round	2092_ma02m33100	2092_ma02m33200	2092_ma02m32100	2092_ja02m32200

Face plate Finish	Backset in mm	Face Plate Form	Face plate 24 x 235 mm Function D single-leaf / PZ-72		Face plate 24 x 235 mm Function E single-leaf / PZ-72	
			DIN left	DIN right	DIN left	DIN right
Stainless Steel	55	round	2092_ha02m35100	2092_ha02m35200	2092_ha02m34100	2092_ha02m34200
	65	round	2092_ja02m35100	2092_ja02m35200	2092_ja02m34100	2092_ja02m34200
	80	round	2092_ma02m35100	2092_ma02m35200	2092_ma02m34100	2092_ma02m34200

Face plate Finish	Backset in mm	Face Plate Form	Face plate 20 x 235 mm Function B inward single-leaf / PZ-72		Face plate 24 x 235 mm Function B inward single-leaf / PZ-72	
			DIN left	DIN right	DIN left	DIN right
Stainless steel	65	round	2092_ja02h37100	2092_ja02h37200	2092_ja02m37100	2092_ja02m37200

Face plate Finish	Backset in mm	Face Plate Form	Face plate 20 x 235 mm Function C inward single-leaf / PZ-72		Face plate 24 x 235 mm Function C inward single-leaf / PZ-72	
			DIN left	DIN right	DIN left	DIN right
Stainless steel	65	round	2092_ja02h38100	2092_ja02h38200	2092_ja02m38100	2092_ja02m38200

Face plate Finish	Backset in mm	Face Plate Form	Face plate 20 x 235 mm Function D inward single-leaf / PZ-72		Face plate 24 x 235 mm Function D inward single-leaf / PZ-72	
			DIN left	DIN right	DIN left	DIN right
Stainless steel	65	round	2092_ja02h39100	2092_ja02h39200	2092_ja02m39100	2092_ja02m39200

Face plate Finish	Backset in mm	Face Plate Form	Face plate 20 x 235 mm Function B / CH-RZ		Face plate 24 x 235 mm Function B / CH-RZ	
			DIN left	DIN right	DIN left	DIN right
Stainless steel	65	round	2092_jd02h33100	2092_jd02h33200	2092_jd02m33100	2092_jd02m33200



Product characteristics		
Lock type	PZ-72	■
	RZ-74	■
Backset	55, 65, 80	■
Panic function	B	■
	C	■
	D	■
	E	■
Face plate	Stainless steel	■
Face plate width	20, 24	■
Hub	9 mm	■
Suitable for the use on fire- and smoke control doors	F	■
Tested according to DIN / EN	<div style="display: flex; gap: 5px;"> <div style="border: 1px solid black; padding: 2px;">EN 179 </div> <div style="border: 1px solid black; padding: 2px;">EN 1125 </div> </div> <div style="display: flex; gap: 5px; margin-top: 5px;"> <div style="border: 1px solid black; padding: 2px;">DIN 18 250</div> <div style="border: 1px solid black; padding: 2px;">EN 12 209</div> </div>	
<input checked="" type="checkbox"/> Yes - No <input type="checkbox"/> On request		
<div style="display: flex; justify-content: space-around; align-items: center;"> <div style="text-align: center;"> <p>Steel door</p> </div> <div style="text-align: center;"> <p>Wooden door</p> </div> </div>		

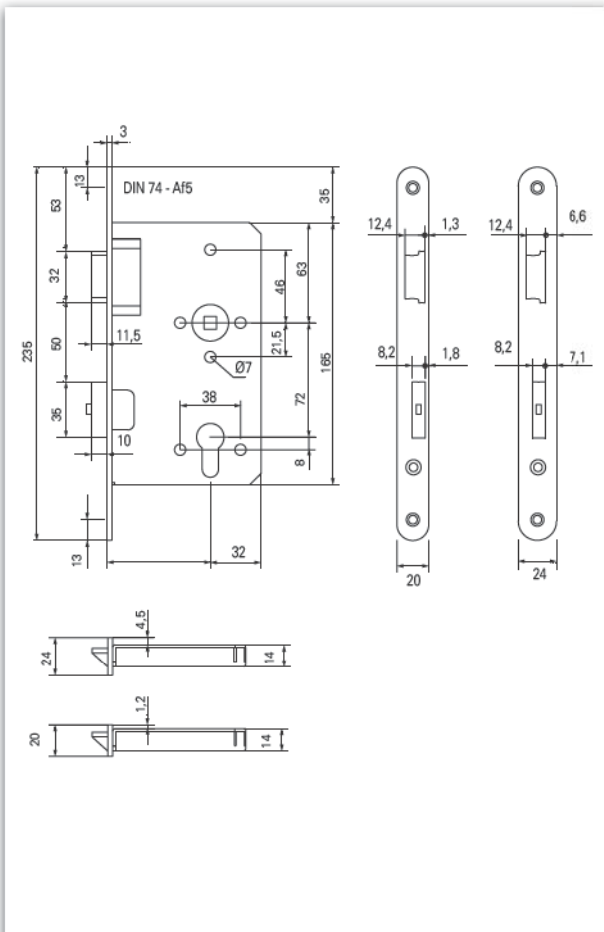

Description

- Panic mortise lock
- Tested and certified acc. to **EN 179, EN 1125, DIN 18 250** and **EN 12 209**
- For double-leaf wooden and steel doors as well as fire-protection doors
- Face plate square on request

On request individual plate stamping possible at extra charge.

GBS 93 ■ Panic mortise lock for fire-proof doors



Face plate Finish	Backset in mm	Face Plate Form	Face plate 20 x 235 mm Function B double-leaf / PZ-72		Face plate 20 x 235 mm Function C double-leaf / PZ-72	
			DIN left	DIN right	DIN left	DIN right
Stainless Steel	55	round	2093aha02h33100	2093aha02h33200	2093aha02h32100	2093aha02h32200
	65	round	2093aja02h33100	2093aja02h33200	2093aja02h32100	2093aja02h32200
	80	round	2093ama02h33100	2093ama02h33200	2093ama02h32100	2093ama02h32200

Face plate Finish	Backset in mm	Face Plate Form	Face plate 20 x 235 mm Function D double-leaf / PZ-72		Face plate 20 x 235 mm Function E double-leaf / PZ-72	
			DIN left	DIN right	DIN left	DIN right
Stainless Steel	55	round	2093aha02h35100	2093aha02h35200	2093aha02h34100	2093aha02h34200
	65	round	2093aja02h35100	2093aja02h35200	2093aja02h34100	2093aja02h34200
	80	round	2093ama02h35100	2093ama02h35200	2093ama02h34100	2093ama02h34200

Face plate Finish	Backset in mm	Face Plate Form	Face plate 24 x 235 mm Function B double-leaf / PZ-72		Face plate 24 x 235 mm Function C double-leaf / PZ-72	
			DIN left	DIN right	DIN left	DIN right
Stainless Steel	55	round	2093aha02m33100	2093aha02m33200	2093aha02m32100	2093aha02m32200
	65	round	2093aja02m33100	2093aja02m33200	2093aja02m32100	2093aja02m32200
	80	round	2093ama02m33100	2093ama02m33200	2093ama02m32100	2093ama02m32200

Face plate Finish	Backset in mm	Face Plate Form	Face plate 24 x 235 mm Function D double-leaf / PZ-72		Face plate 24 x 235 mm Function E double-leaf / PZ-72	
			DIN left	DIN right	DIN left	DIN right
Stainless Steel	55	round	2093aha02m35100	2093aha02m35200	2093aha02m35400	2093aha02m34200
	65	round	2093aja02m35100	2093aja02m35200	2093aja02m35400	2093aja02m34200
	80	round	2093ama02m35100	2093ama02m35200	2093ama02m35400	2093ama02m34200

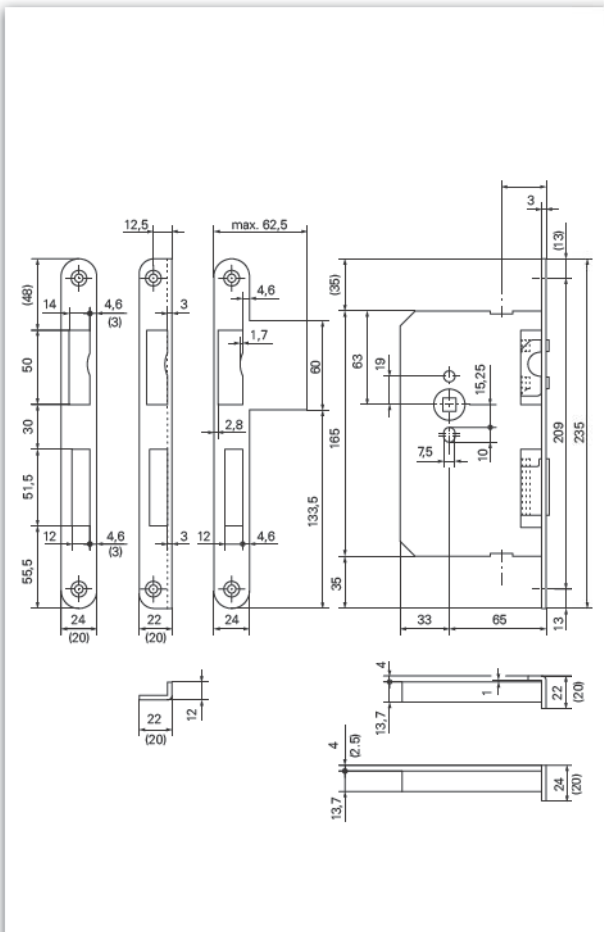

Product characteristics		
Panic function		■
Face plate	Stainless steel	■
Backset	65, 80, 100	■
STF	30, 45, 65	■
Face plate width	20, 24	■
Face plate types	Face plate	■
	Angular face plate	■
	Flat face plate	■
Hub	9 mm	■
Suitable for the use on fire- and smoke control doors	F	■
Tested according to DIN / EN	EN 179	<input checked="" type="checkbox"/>
	EN 1125	<input checked="" type="checkbox"/>
	EN 12 209	<input checked="" type="checkbox"/>
■ Yes - No <input type="checkbox"/> On request		
 Steel door  Wooden door		

Description

- Panic mortise lock for double-leaf fire-proof doors
- Suitable for fire-protection doors
- Tested and certified acc. to **EN 179**, **EN 1125** and **EN 12 209**
- Made completely of fire-resistant materials
- Related lock for active leaf GBS 93 on page 500.

On request individual plate stamping possible at extra charge.

Dimensioning: GBS 94



GBS 94 ■ Panic counter lock for double-leaf fire proof doors

Face plate Finish	Backset in mm	STF	Face Plate Form	Face plate 20 x 235 mm Face plate		Face plate 24 x 235 mm Face plate	
				DIN left	DIN right	DIN left	DIN right
Stainless Steel	65	30	round	2094aja02h33100	2094aja02h33200	2094aja02m33100	2094aja02m33200
	80	30	round	2094ama02h33100	2094ama02h33200	2094ama02m33100	2094ama02m33200
	80	45	round	2094ama02h33100	2094ama02h33200	2094ama0233104	2094ama02m33204
	100	65	round	2094aqa02h33100	2094aqa02h33204	2094aqa02h33100	2094aqa02m33200

Face plate Finish	Backset in mm	STF	Face Plate Form	Face plate 20 x 12 x 235 mm Angular face plate		Face plate 22 x 12 x 235 mm Angular face plate	
				DIN left	DIN right	DIN left	DIN right
Stainless Steel	65	30	round	2094aja02v33100	2094aja02v33200	2094aja02w33100	2094aja02w33200
	80	30	round	2094ama02v33100	2094ama02v33200	2094ama02w33100	2094ama02w33200
	80	45	round	2094ama02v33100	2094ama02v33200	2094ama02w33104	2094ama02w33204
	100	65	round	2094aqa02v33100	2094aqa02v33204	2094aqa02w33100	2094aqa02w33200

Face plate Finish	Backset in mm	STF	Face Plate Form	Face plate 20 x 12 x 235 mm / max. 62,5 mm Flat face plate		Face plate 22 x 12 x 235 mm / max.62,5 mm Flat face plate	
				DIN left	DIN right	DIN left	DIN right
Stainless Steel	65	30	round	2094aja02x33100	2094aja02x33200	2094aja02x33100	2094aja02x33200
	80	30	round	2094ama02x33100	2094ama02x33200	2094ama02x33100	2094ama02x33200
	80	45	round	2094ama02x33100	2094ama02x33200	2094ama02x33104	2094ama02x33204
	100	65	round	2094aqa02x33100	2094aqa02x33204	2094aqa02x33100	2094aqa02x33200



Product characteristics		
Backset	25, 30, 35, 40, 45, 65	■
Face plate	Stainless steel	■
Face plate width	20, 24	■
Face plate width	18	□
Stulpform	round / square	
Suitable for the use on fire- and smoke control doors	F	■
■ Yes - No □ On request		
 Steel door  Wooden door  Profile frame door		

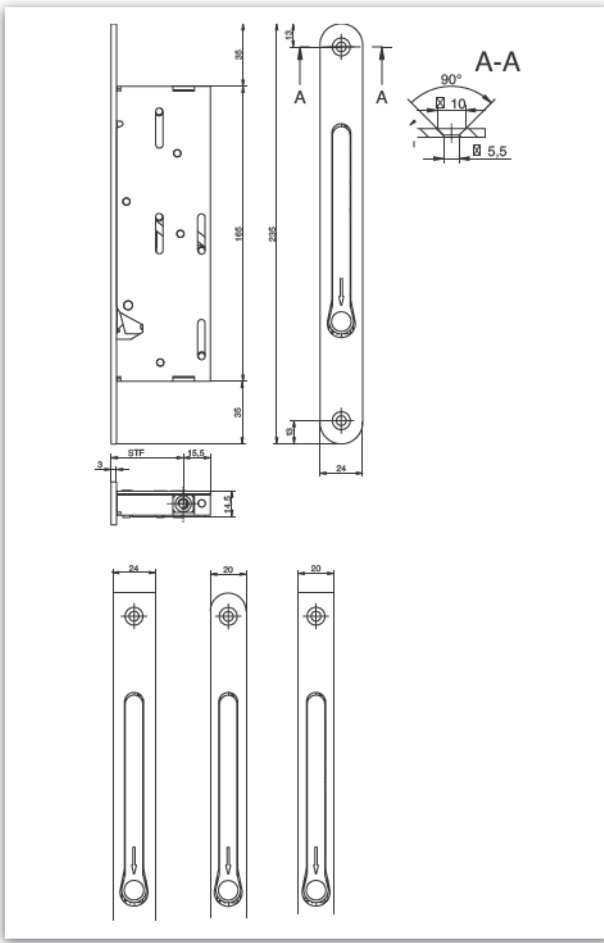

Description

- Tested and certified according to **EN 12 209**
- Fire protection certified
- Control lever Stainless steel
- Secure execution

On request individual plate stamping possible at extra charge.

GBS 94f ■ Rebate dead bolt lock



Face plate Finish	Backset	Face Plate Form	Face plate 20 x 235 mm
Stainless Steel	25	round	2094fb000h30000
	30	round	2094fc000h30000
	35	round	2094fd000h30000
	40	round	2094fe000h30000
	45	round	2094ff000h30000
	65	round	2094fj000h30000

Face plate Finish	Backset	Face Plate Form	Face plate 20 x 235 mm
Stainless Steel	25	square	2094fb000f30000
	30	square	2094fc000f30000
	35	square	2094fd000f30000
	40	square	2094fe000f30000
	45	square	2094ff000f30000
	65	square	2094fj000f30000

Face plate Finish	Backset	Face Plate Form	Face plate 24 x 235 mm
Stainless Steel	25	round	2094fb000m30000
	30	round	2094fc000m30000
	35	round	2094fd000m30000
	40	round	2094fe000m30000
	45	round	2094ff000m30000
	65	round	2094fj000m30000

Face plate Finish	Backset	Face Plate Form	Face plate 24 x 235 mm
Stainless Steel	25	square	2094fb000k30000
	30	square	2094fc000k30000
	35	square	2094fd000k30000
	40	square	2094fe000k30000
	45	square	2094ff000k30000
	65	square	2094fj000k30000



Product characteristics		
Lock type	PZ-92	■
Backset	30, 35, 40, 45	■
Panic function	B	■
	D	■
	E	■
Face plate	Stainless steel	■
Face plate width	24	■
Hub	9 mm	■
Suitable for the use on fire- and smoke control doors	F	■
Tested acc. EN / DIN	EN 179  EN 1125 	
■ Yes - No □ On request		
 Wooden door  Profile frame door		

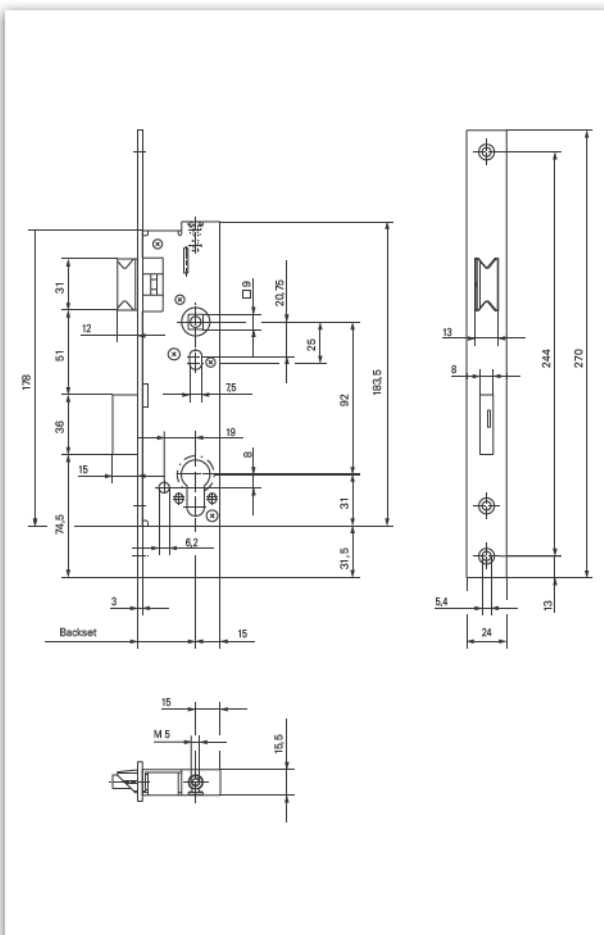

Dimensioning: GBS 96

Description

- Panic mortise lock
- Suitable for fire-protection doors
- Tested and certified acc. to **EN 179** and **EN 1125**
- Made completely of fire-resistant materials
- Panic function E: same version DIN left / DIN right
- Additional top-bolting on request

On request individual plate stamping possible at extra charge.





GBS 96 ■ Panic mortise lock for fire-proof doors

Face plate Finish	Backset in mm	Face Plate Form	Face plate 24 x 270 mm Function B / PZ-92	
			DIN left	DIN right
Stainless Steel	30	square	2096acb02q33100	2096acb02q33200
	35	square	2096adb02q33100	2096adb02q33200
	40	square	2096aeb02q33100	2096aeb02q33200
	45	square	2096afb02q33100	2096afb02q33200

Face plate Finish	Backset in mm	Face Plate Form	Face plate 24 x 270 mm Function D / PZ-92	
			DIN left	DIN right
Stainless Steel	30	square	2096acb02q35100	2096acb02q35200
	35	square	2096adb02q35100	2096adb02q35200
	40	square	2096aeb02q35100	2096aeb02q35200
	45	square	2096afb02q35100	2096afb02q35200

Face plate Finish	Backset in mm	Face Plate Form	Face plate 24 x 270 mm Function E / PZ-92 W (W = handle / knob execution)	
			DIN left	DIN right
Stainless Steel	30	square	2096acb02q34000	2096acb02q34000
	35	square	2096adb02q34000	2096adb02q34000
	40	square	2096aeb02q34000	2096aeb02q34000
	45	square	2096afb02q34000	2096afb02q34000



Product characteristics		
Lock type	PZ-92	■
	RZ-94	□
Backset	30, 35, 40, 45	■
Panic function	B	■
	D	■
	E	■
Face plate	Stainless steel	■
Face plate width	24	■
Hub	9 mm	■
Suitable for the use on fire- and smoke control doors	F	■
Tested acc. EN / DIN	EN 179  EN 1125 	
■ Yes - No □ On request		
 Wooden door  Profile frame door		

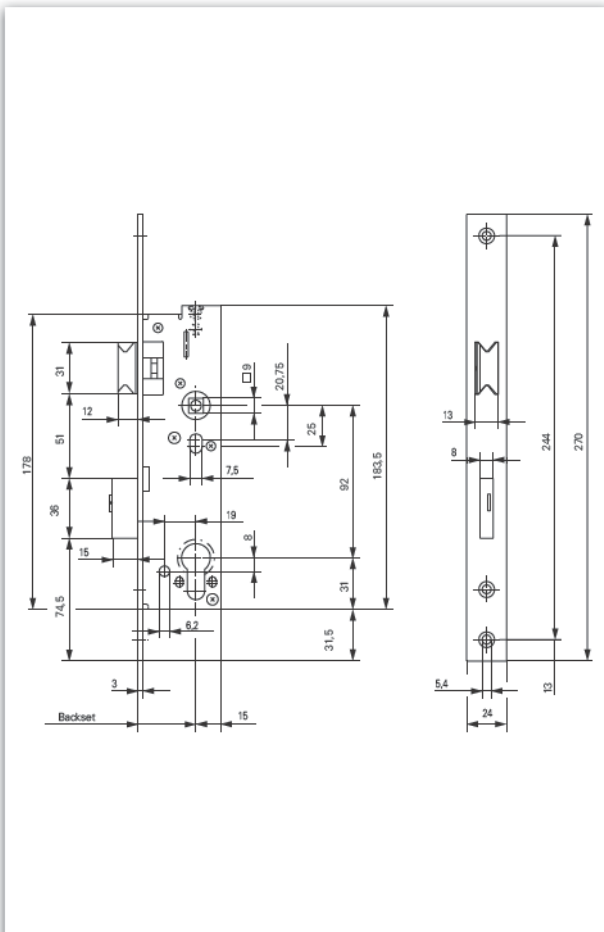

Dimensioning: GBS 97

Description

- Panic mortise lock
- Suitable for fire-protection doors
- Tested and certified acc. to **EN 179** and **EN 1125**
- Made completely of fire-resistant materials
- Panic function E: same version DIN left / DIN right
- Additional top-bolting on request

On request individual plate stamping possible at extra charge.

GBS 97 ■ Panic mortise lock for fire-proof doors

Face plate Finish	Backset in mm	Face Plate Form	Face plate 24 x 270 mm Function B / PZ-92	
			DIN left	DIN right
Stainless Steel	30	square	2097acb02q33100	2097acb02q33200
	35	square	2097adb02q33100	2097adb02q33200
	40	square	2097aeb02q33100	2097aeb02q33200
	45	square	2097afb02q33100	2097afb02q33200

Face plate Finish	Backset in mm	Face Plate Form	Face plate 24 x 270 mm Function D / PZ-92	
			DIN left	DIN right
Stainless Steel	30	square	2097acb02q35100	2097acb02q35200
	35	square	2097adb02q35100	2097adb02q35200
	40	square	2097aeb02q35100	2097aeb02q35200
	45	square	2097afb02q35100	2097afb02q35200

Face plate Finish	Backset in mm	Face Plate Form	Face plate 24 x 270 mm Function E / PZ-92 W (W = handle / knob execution)	
			DIN left	DIN right
Stainless Steel	30	square	2097acb02q34000	2097acb02q34000
	35	square	2097adb02q34000	2097adb02q34000
	40	square	2097aeb02q34000	2097aeb02q34000
	45	square	2097afb02q34000	2097afb02q34000

GBS 98

Product characteristics		
Backset	35, 40, 45, 50, 55, 60, 65	■
Panic function		■
Face plate	Stainless steel Steel zinc-plated	■ ■
Face plate width	24	■
Hub	9 mm	■
Suitable for the use on fire- and smoke control doors	F	■
Tested acc. EN / DIN	EN 179  EN 1125 	
<input type="checkbox"/> Yes - No <input type="checkbox"/> On request		
 Wooden door  Profile frame door		

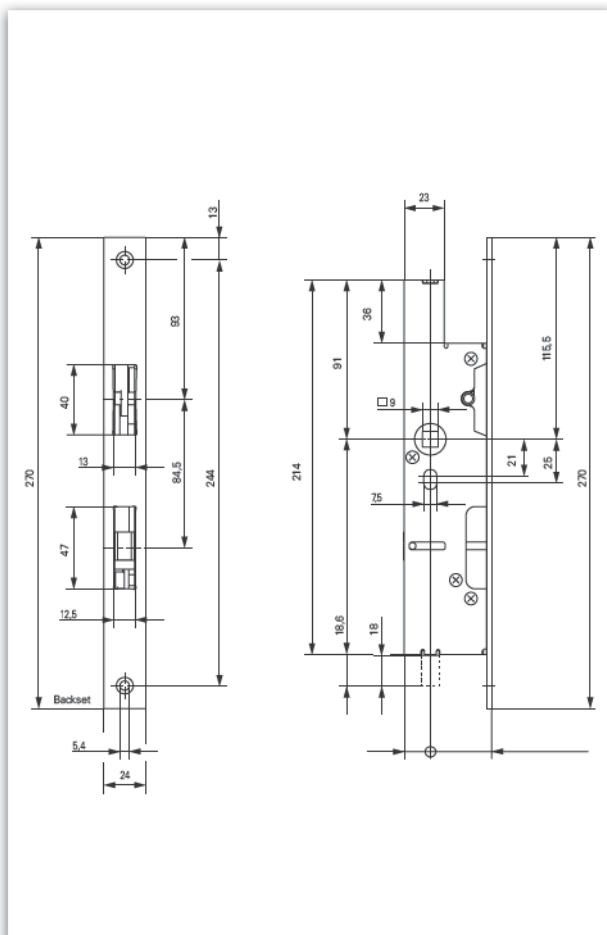

Dimensioning: GBS 98

Description

- Panic counter lock / passive leaf
- For double-leaf fire proof doors
- Safety requirements acc. to **EN 179** and **EN 1125**
- Made completely of fire-resistant materials

On request individual plate stamping possible at extra charge.

GBS 98 ■ Panic counter lock for fire-proof doors

Face plate Finish	Backset in mm	Face Plate Form	Face plate 24 x 270 mm
Stainless Steel	35	square	2098ad002q31000
	40	square	2098ae002q31000
	45	square	2098af002q31000
	50	square	2098ag002q31000
	55	square	2098ah002q31000
	60	square	2098ai002q31000
	65	square	2098aj002q31000